

NOTICE!!

These documents have been scanned!

Do not place un-scanned documents beneath this notice!

Do not remove this notice from this file!

GPO Jacket No. 560-102
Print Order 61540
Rise Business Services, LLC
Job=AZ15 6/24/2019



Box Number= AZ15129



Claim Begin-End: AMC427434-AMC427437

1 Initial Receipt



AZ15129-11

AMC364820-AMC427442

United States Department of the Interior
Bureau of Land Management
 LANDS/RECREATION & PLANNING
 ONE N CENTRAL AVE
 PHOENIX, AZ 85004 -2203
 Phone: 602-417-9200

Receipt

No: 3143765

Transaction #: 3235960	
Date of Transaction: 10/06/2014	
CUSTOMER:	
PATRICIA STEINMETZ PO BOX 953 CONGRESS, AZ 85332-0953 US	

LINE #	QTY	DESCRIPTION	REMARKS	UNIT PRICE	TOTAL
1	1.00	LOCATABLE MINERALS / MINING CLAIMS- NOT NEW-UNADJUD, ONE AUTH NO. ONLY / MINING CLAIM MONEY RECEIVED CASES: AMC427437/\$30.00	AMEND (3)	- n/a -	30.00
TOTAL:					\$30.00

PAYMENT INFORMATION					
1	AMOUNT:	30.00	POSTMARKED:	N/A	
	TYPE:	CASH	RECEIVED:	10/06/2014	
	NAME:	STEINMETZ, PATRICIA PO BOX 953 CONGRESS AZ 85332-0953 US			

REMARKS

This receipt was generated by the automated BLM Collections and Billing System and is a paper representation of a portion of the official electronic record contained therein.

\$10 FOR AMENDMENT ON 426140 - RED METAL - RM ENTERED 10/22/2014.

** Receipt used to earn:
 AMC 426140 (amend to reduce length)
 AMC 427437 (amend to reduce acres)
 AMC 427435 (correct) (LD)*

** All attached on RE 10/28/14
 top of orig. loc. notice. 10/6/2014*

CRUCES ;

Stockmyer South

PAID \$20⁰⁰-

State of Az Mass

Johnathan Tapp

11 ~~B~~ Fox CANYON Rd =



Send To:
Patricia Steinmetz
Po Box 953
Congress, AZ
85332

Correction for Amendment of Location Notice for AMC 427437
Instrument number 2014-0032850

The purpose of this document is to amend the Location Notice AMC 427437
filed with the Yavapai County Recorders Office instrument number 2014-0009164

1) Re: Snowflake Fraction Placer, 37 Pub. Lands Dec. 250 (1908)

Re: 1 or 2 Locators

The boundaries of this claim are within the boundaries of
a 40 acre square parcel.

2) The West Boundary line of AMC 427437 Stockmyer South Ext
is bordered by the existing East Boundary line of AMC 418634

3) Change the legal description of the above mentioned claim to conform with new
boundaries.

4) As per request of Rod Ebert, Public Office BLM Pheonix, Az.

RECEIVED
M AZ STATE OFFICE
2014 OCT -6 P 2:24
PHOENIX, ARIZONA

AMENDMENT FOR LOCATION NOTICE FOR PLACER MINING CLAIM

NOTICE IS HEREBY GIVEN

that the Stockmyer South Ext AMC427437

placer mining claim has been located by

Ronald Posey

whose current mailing address is

4598 Hawaina Way
Kelseyville, Ca 95451

The general course of this claim is North to South and it is situated in Yavapai County, Arizona.

This Claim is irregular in shape

Beginning at the SE corner monument on which this location notice is posted course due West 1320 ft to the SW corner, then course 510 ft. due North to the next corner then course 865 ft at 21 degrees NE to the NW corner then, course 1020 ft due East to the NE corner, then course 1320 ft due South back to the beginning at the SE corner of this claim.

This claim is marked by 5 monuments, one at each corner of the claim

The location monument on which this notice is posted is situated within Section 25, Township 9N, Range 5W Gila and Salt River Meridian, Weaver Mining District, Yavapai County, Arizona.

This claim encompasses portions of the following quarter section(s), NW of section 25, T9N, R5W, Gila and Salt River Meridian, Weaver Mining District, Yavapai County, Arizona.

The locality of this claim with reference to some natural object or permanent monument and additional information (if any) concerning its locality is as follows:

1. The SE corner of the claim is 2640 feet due South then 2640 ft due West of the NE corner survey monument of Section 25, T9N, R5W Gila and Salt River Meridian, Weaver Mining District, Yavapai County, Arizona.

DATED AND POSTED on the ground this 26th day of, February 2014.

LOCATOR(s) Ronald Posey Ronald Posey
Mary Posey Mary Posey
 Agent Only () _____

RECEIVED
 BLM AZ STATE OFFICE
 2014 AUG 19 P 1:42
 PHOENIX, ARIZONA
 BLM
 Date
 Stamp

RECEIVED
 BLM AZ STATE OFFICE
 2014 OCT 6 P 2:24
 PHOENIX, ARIZONA

Location Notice for Placer Mining Claim
AMENDMENT AMC 427437
MINING CLAIM MAP

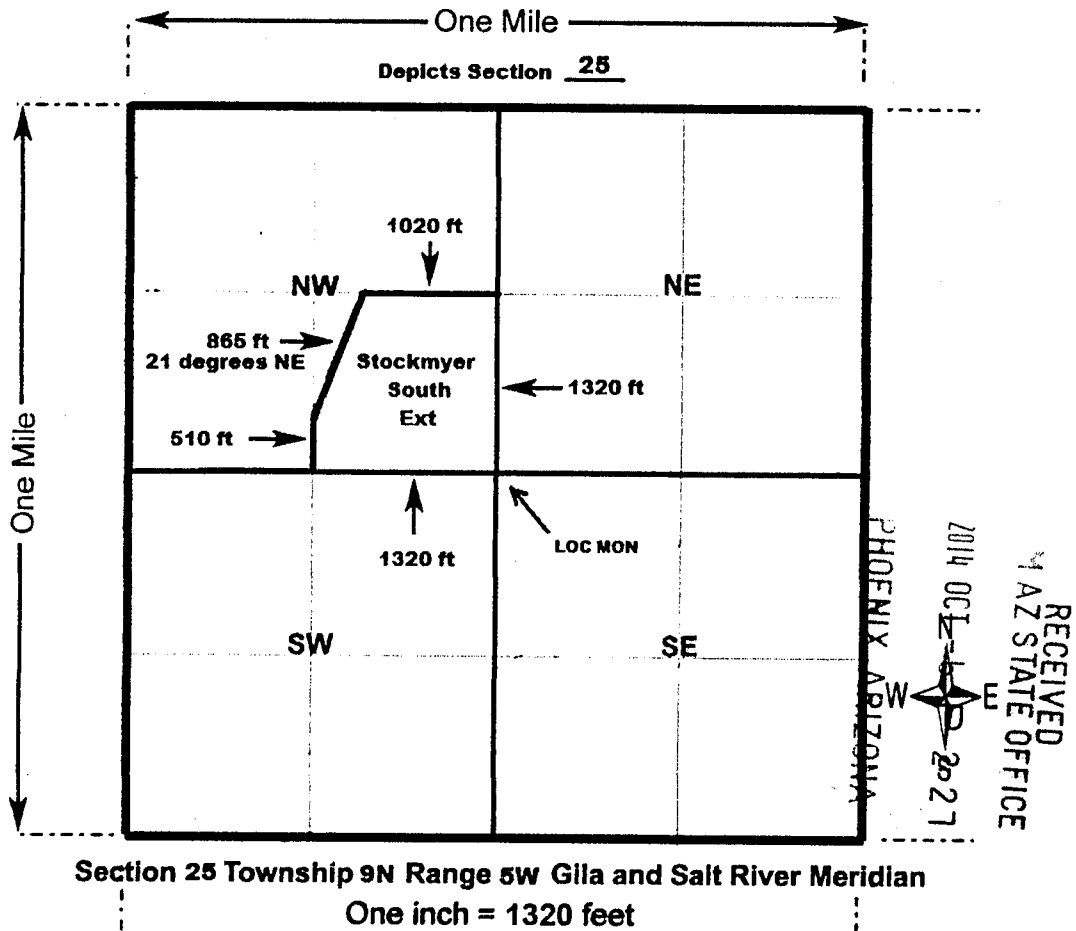

1. The above map depicts the STOCKMYER SOUTH EXT placer mining claim located in Section 25 Township 9N Range 5W Gila and Salt River Meridian, WEAVER MINING District, YAVAPAI County, Arizona.
2. The Type of corner and location monuments used are 2 inch white PVC posts more than 4 foot tall.
3. The bearings and distances in degrees and feet feet between claim corners are as depicted on the above map.

Location Notice for Placer Mining Claim

AMENDMENT AMC 427437

MINING CLAIM MAP

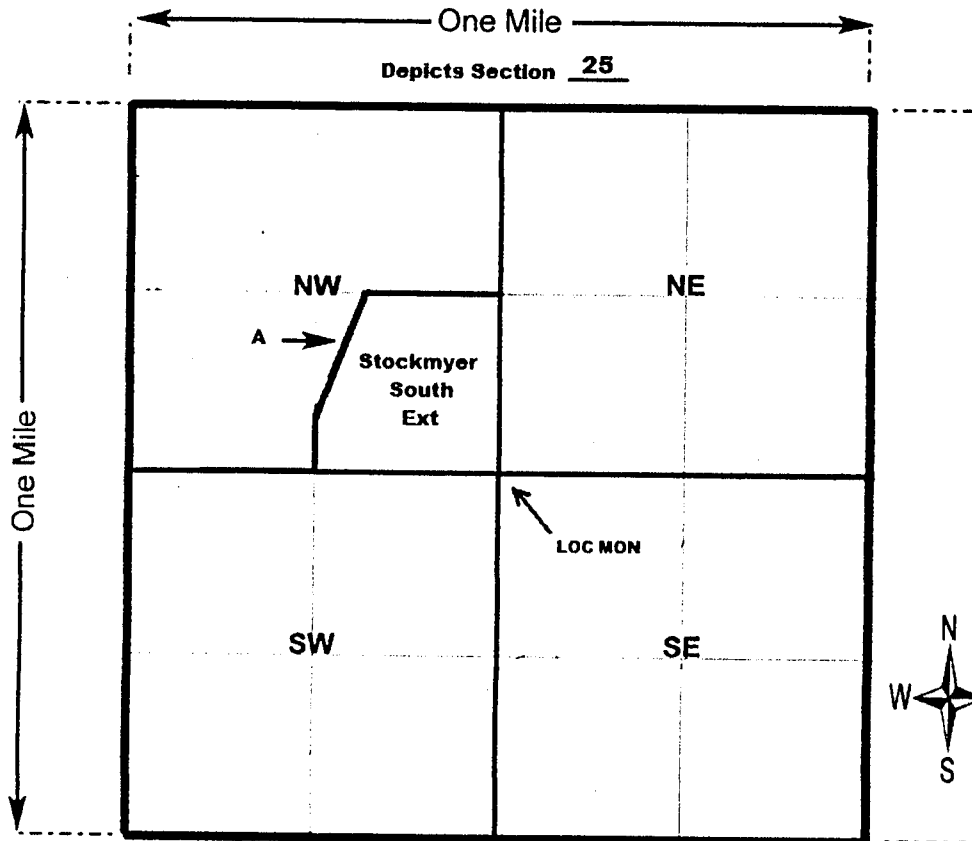

Section 25 Township 9N Range 5W Gila and Salt River Meridian

One inch = 1320 feet

1. The above map depicts the STOCKMYER SOUTH EXT placer mining claim located in Section 25 Township 9N Range 5W Gila and Salt River Meridian, WEAVER MINING District, YAVAPAI County, Arizona.

CLAIM IS BORDERED ON DEPICTED SIDE(S) BY THE FOLLOWING CLAIM(S)

A) AMC 418634

RECEIVED
M AZ STATE OFFICE
2014 OCT - 6 P 2: 24
PHOENIX, ARIZONA

United States Department of the Interior
Bureau of Land Management
 LANDS/RECREATION & PLANNING
 ONE N CENTRAL AVE
 PHOENIX, AZ 85004 -2203
 Phone: 602-417-9200

Receipt

No: 3105778

Transaction #: 3197428	
Date of Transaction: 08/19/2014	
CUSTOMER:	
MELBURN VROOMAN PO BOX 814 CONGRESS, AZ 85332-0814 US	

LINE #	QTY	DESCRIPTION	REMARKS	UNIT PRICE	TOTAL
1	1.00	LOCATABLE MINERALS / MINING CLAIMS- NOT NEW-UNADJUD, ONE AUTH NO. ONLY / MINING CLAIM MONEY RECEIVED CASES: AMC427437/\$30.00	AMEND (3)	- n/a -	30.00
TOTAL:					\$30.00

PAYMENT INFORMATION			
NOTE: Items will appear on credit card statement as "Bureau of Land Mgmt CO".			
1	AMOUNT:	30.00	POSTMARKED: N/A
	TYPE:	CREDIT CARD	RECEIVED: 08/19/2014
	NAME:	STEINMETZ, PATRICIA PO BOX 953 CONGRESS AZ 85332-0814 US	
	CARD NO:	XXXXXXXXXXXX4308	AUTH CODE: 104115
	NAME ON CARD:	PATRICIA M STEINMETZ	
	EXPIRES:	04/2018	
	SIGNATURE:		

REMARKS

This receipt was generated by the automated BLM Collections and Billing System and is a paper representation of a portion of the official electronic record contained therein.

Earned Amendment for:
~~AMC427437~~
 AMC426138
 AMC426139
 AMC426141



Send To:
Mel Vrooman
Po Box 814
Congress AZ
85332

**The purpose of this amendment is to amend the Location Notice AMC 427437
filed with the Yavapai County Recorders Office instrument number 2014-0009161**

- 1) Adjust the West Boundary line of the above mentioned claim to conform with Federal mining regulations requiring no more than 1320 feet in length of any side or end line.**
- 2) Change the legal description of the above mentioned claim to conform with new boundaries.**
- 3) As per request of Rod Ebert, Public Office BLM Pheonix, Az.**

RECEIVED
M AZ STATE OFFICE
2014 AUG 19 P 1:41
PHOENIX, ARIZONA

Corrected AMC 427437

The purpose of this document is to clarify the amendment of the Location Notice for AMC 427437 Stockmyer South Ext

Original filing, Yavapai County Recorders Office instrument number 2014-0009161

Amendment filing, Yavapai County Recorders Office instrument number 2014-0032850

1) Re: Snowflake Fraction Placer, 37 Pub.Lands Dec. 250 (1908)

The boundaries of this claim fit within the boundary's of a 40 acre square parcel.

2) Re: 43 CFR 3832.12 (c) (1) (iii)

The non-aliquot West Boundary line of AMC 427437 follows the existing Red Solo Cup (AMC 418633) East Boundary line therefore this claim is described in metes and bounds.

3) As per request of Rod Ebert, State Office, BLM Phoenix, AZ.

RECEIVED
BLM AZ STATE OFFICE
2014 AUG 19 P 1:53
PHOENIX, ARIZONA



Send To:
Mel Vrooman
Po Box 814
Congress AZ
85332

The purpose of this amendment is to amend the Location Notice AMC 427437
filed with the Yavapai County Records Office instrument number 2014-0009161

- 1) Adjust the West Boundary line of the above mentioned claim to conform with Federal mining regulations requiring no more than 1320 feet in length of any side or end line.
- 2) Change the legal description of the above mentioned claim to conform with new boundaries.
- 3) As per request of Rod Ebert, Public Office BLM Pheonix, Az.

Bordered By Another claim

RECEIVED
BLM AZ STATE OFFICE
2014 AUG 19 P 1:53
PHOENIX, ARIZONA

United States Department of the Interior
Bureau of Land Management
 LANDS/RECREATION & PLANNING
 ONE N CENTRAL AVE
 PHOENIX, AZ 85004 -2203
 Phone: 602-417-9200

ENTERED
 . MAR 17 2014
 BY: *RAM*

Receipt

No: 2979276

Transaction #: 3067933	
Date of Transaction: 02/28/2014	
CUSTOMER:	
RONALD POSEY 4598 HAWAINA WAY KELSEYVILLE, CA 95451-9756 US	

LINE #	QTY	DESCRIPTION	REMARKS	UNIT PRICE	TOTAL
1	4.00	LOCATABLE MINERALS / MINING CLAIMS-NEW, UNADJUD, ONE OR MORE AUTH NOS / NEW MINING CLAIM LOCATION FEE \$34 CASES: AMC427434/\$34.00, AMC427435/\$34.00, AMC427436/\$34.00, AMC427437/\$34.00		- n/a -	136.00
2	4.00	LOCATABLE MINERALS / MINING CLAIMS-NEW, UNADJUD, ONE OR MORE AUTH NOS / NEW MINING CLAIM PROCESSING FEE CASES: AMC427434/\$20.00, AMC427435/\$20.00, AMC427436/\$20.00, AMC427437/\$20.00		- n/a -	80.00
3	4.00	LOCATABLE MINERALS / MINING CLAIMS-NEW, UNADJUD, ONE OR MORE AUTH NOS / NEW MINING CLAIM MAINT FEE \$140 CASES: AMC427434/\$140.00, AMC427435/\$140.00, AMC427436/\$140.00, AMC427437/\$140.00		- n/a -	560.00
4	1.00	LOCATABLE MINERALS / MINING CLAIMS-NOT NEW-UNADJUD, ONE AUTH NO. ONLY / MINING CLAIM MONEY RECEIVED CASES: AMC427434/\$560.00	NEW ASSOC PLACER LOCATION	- n/a -	560.00
TOTAL:					\$1,336.00

PAYMENT INFORMATION

1	AMOUNT:	1336.00	POSTMARKED:	N/A
	TYPE:	CASH	RECEIVED:	02/28/2014
	NAME:	POSEY, RONALD 4598 HAWAINA WAY KELSEYVILLE CA 95451-9756 US		

REMARKS

This receipt was generated by the automated BLM Collections and Billing System and is a paper representation of a portion of the official electronic record contained therein.

NOTICE!!

These documents have been scanned!

Do not place un-scanned documents beneath this notice!

Do not remove this notice from this file!

GPO Jacket No. 560-102
Print Order 61540
Rise Business Services, LLC
Job=AZ15 6/24/2019



Box Number= AZ15129



Claim Begin-End: AMC427434-AMC427437

2 Correspondence



AZ15129-11

AMC364820-AMC427442

**NO
DOCUMENTS
FOUND**

NO DOCUMENTS FOUND
NO DOCUMENTS FOUND

NOTICE!!

These documents have been scanned!

Do not place un-scanned documents beneath this notice!

Do not remove this notice from this file!

GPO Jacket No. 560-102
Print Order 61540
Rise Business Services, LLC
Job=AZ15 6/24/2019



Box Number= AZ15129



Claim Begin-End: AMC427434-AMC427437

3 Transfers



AZ15129-11

AMC364820-AMC427442

**NO
DOCUMENTS
FOUND**

NO DOCUMENTS FOUND
NO DOCUMENTS FOUND

NOTICE!!

These documents have been scanned!

Do not place un-scanned documents beneath this notice!

Do not remove this notice from this file!

GPO Jacket No. 560-102
Print Order 61540
Rise Business Services, LLC
Job=AZ15 6/24/2019



Box Number= AZ15129



Claim Begin-End: AMC427434-AMC427437

4 Annual Filings



AZ15129-11

AMC364820-AMC427442

UNITED STATES
DEPARTMENT OF THE INTERIOR
BUREAU OF LAND MANAGEMENT
MAINTENANCE FEE WAIVER CERTIFICATION

544
[Handwritten initials]

427434

FORM APPROVED
OMB NO. 1004-0114
Expires: January 31, 2020

SEE INSTRUCTIONS ON PAGE 2

- This small miner waiver is filed for the assessment year beginning on September 1, _____ and ending on September 1, _____.
- The undersigned and all related parties owned ten or fewer mining claims, mill, or tunnel sites located and maintained on Federal lands in the United States of America on September 1, _____.
- The undersigned have performed the assessment work required by law for each mining claim listed prior to filing this waiver and understand that by filing this form, the undersigned must file an affidavit of assessment work with the Bureau of Land Management (BLM) by the December 30th following the filing of this waiver.
- The undersigned understand that if the assessment work obligation has not yet come due under 30 U.S.C. 28 (for those claims in their first assessment year only), a notice of intent to hold reciting this condition must be recorded by the December 30th following the filing of this waiver.
- The undersigned understand that mill and tunnel sites may also be listed on this waiver and be waived from payment of the maintenance fee, and that a notice of intent to hold for these sites is required to be filed with the BLM by the December 30th following the filing of this waiver.
- The undersigned understand and acknowledge that pursuant to 43 U.S.C. 1212 and 18 U.S.C. 1001, the filing or recording of a false, fictitious, or fraudulent document with the BLM may result in a fine of up to \$250,000, a prison term not to exceed five years, or both.
- The mining claims, mill or tunnel sites for which this waiver from payment of the maintenance fees is requested are:

CLAIM OR SITE NAME	BLM RECORDATION SERIAL NUMBER
1. STOCKMYER NORTH	AMC427434
2. STOCKMYER NORTH EXT	AMC427435
3. STOCKMYER SOUTH	AMC427436
4. STOCKMYER SOUTH EXT	AMC427437
5.	
6.	
7.	
8.	
9.	
10.	

RECEIVED
BLM AZ STATE OFFICE
2019 SEP -4 P 1:54
PHOENIX, ARIZONA

The owner(s) (claimants) of the above mining claims and sites are:

5 RONALD POSEY

(Owner's Name - Please Print)
4598 HAWAINA WAY ✓

(Owner's Mailing Address)

Ronald Posey

(Owner's Signature)
KELSEYVILLE CA 95451

(City) (State) (Zip Code)

4 MARY POSEY

(Owner's Name - Please Print)
4598 HAWAINA WAY ✓

(Owner's Mailing Address)

Mary Posey

(Owner's Signature)
KELSEYVILLE CA 95451

(City) (State) (Zip Code)

**POSTMARKED
TIMELY**

(Owner's Name - Please Print)

(Owner's Mailing Address)

(Owner's Signature)
Post Mark date: 8/29/2019
AC483
ENTERED SEP 20 2019
PB

(City) (State) (Zip Code)

(Owner's Name - Please Print)

(Owner's Mailing Address)

(Owner's Signature)

(City) (State) (Zip Code)

4555462

Ronald S. Posey
4598 Hawaina Way
Kelseyville, CA 95451

CA 940
29 AUG 19
PM 2 L

RECEIVED
BLM AZ STATE OFFICE
2019 SEP -4 P 1:54
PHOENIX, ARIZONA

BLM
ARIZONA STATE OFFICE
ONE NORTH CENTRAL AVE
SUITE 800
PHOENIX, AZ 85004



1000



85004

U.S. POSTAGE PA
FORM LETTER
LAKEPORT, CA
95453
AUG 29 19
AMOUNT
\$0.55
R2305M148870-15

POSTMARKED
TIMELY

85004-442700

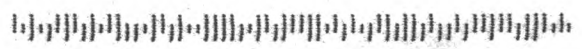

UNITED STATES
DEPARTMENT OF THE INTERIOR
BUREAU OF LAND MANAGEMENT

FORM APPROVED 426220
OMB NO.: 1004-0114
Expires: January 31, 2020

427434

AFFIDAVIT OF ANNUAL ASSESSMENT WORK

WHEN RECORDED, MAIL DOCUMENT TO:

NAME: RONALD POSEY

ADDRESS: 4598 HAWAINA WAY

CITY, STATE, ZIP: KELSEYVILLE, CA 95451

434563
433892
435529

FOR COUNTY RECORDER'S USE

No. of Claims 1

x \$10/claim

Total due BLM \$ 10.00

TO ALL WHOM IT MAY CONCERN:

1. The undersigned certifies that at least \$100 per claim was expended for development, labor and improvements, or equivalent value added, as the annual assessment work for the assessment year ending September 1, 2018 for the following contiguous unpatented mining claim(s), located in the County of YAVAPAI, in the State of ARIZONA.

BLM Serial No.	Name of Claim	Tp	Rg	Sec	Mer	County Recordation Book and Page No.	Co. Recording Date
AMC426221	Better Than Nothing2	9N	4W	20	GSR	2014-0003094	12/17/2013

RECEIVED
 BLM AZ STATE OFFICE
 SEP -5 P 2:27
 PHOENIX, ARIZONA

4260036

(Continued on page 2)

ENTERED
 SEP 18 2018
 BY: Ryam

2. Type of labor and improvements (specify what was done and give the total value for that labor and improvement to show at least \$100 for each claim). If a geological, geochemical, or geophysical survey was performed, as per 30 U.S.C. 28-1, reference the title of the report of survey, give cost and date of the survey and report, and indicate it was filed with the County Recorder:

Description of Work Performed	Value of Work Performed	Date Work Was Performed
CLAIM IMPROVEMENTS	140.00	2017 - 2018

3. Name and mailing address of each person who performed the labor and improvements:

Name (please print)

RONALD POSEY

WALTER POSEY

Current Mailing Address (please print)

4598 HAWAIIA WAY KELSEYVILLE, CA 95451

P.O. BOX 95 SAN LEANDRO, CA 94577

4. Name and mailing address of each person who holds and claims the subject mining claim(s) for the valuable minerals contained therein. Be sure to indicate if there is a change of address:

Name (please print)

RONALD POSEY

WALTER POSEY

Current Mailing Address (please print)

4598 HAWAIIA WAY KELSEYVILLE, CA 95451

P.O. BOX 95 SAN LEANDRO, CA 94577

RECEIVED
 BLM
 AZ STATE OFFICE
 PHOENIX, ARIZONA
 2018 SEP - 5 P 2:27

5. The undersigned testifies that on the date of July 27, 2018, all monuments required by law were erected upon the subject claim(s), and all notices required by law were posted on the subject claim(s) or copies thereof were in place, and at said date, each corner monument bore or contained

markings sufficient to appropriately designate the corner of the claim to which it pertains and the name of the claim(s).

I hereby certify under penalty of perjury under the laws of the State of ARIZONA that the foregoing statements are true and correct:

Ronald Posey

Date: Aug 26, 2018

(Signature of person responsible for above statement)

Title 18 U.S.C. 1001 and 43 U.S.C. 1212 make it a crime for any person knowingly and willfully to make to any department or agency of the United States any false, fictitious or fraudulent statements or representations as to any matter within its jurisdiction.

Notary Block

SUBSCRIBED AND SWORN TO before me, this 26th day of August 2018

By: Sophia Koot
(Signature of Affiant)

Title: Notary Public

My Commission Expires: JAN. 27th, 2021

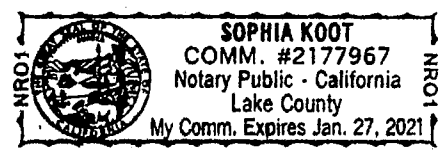

INSTRUCTIONS *see attached affidavit.*

1. This is an optional form that may be used to satisfy the requirements for the Bureau of Land Management (BLM) under the provisions of 43 U.S.C. §1744 and 30 U.S.C. §28-28d and the regulations thereunder (43 CFR part 3835). Since local and State laws may vary, you should contact your local and State agencies where the claims are located to ensure all applicable laws and requirements are satisfied.
2. The claimant(s) must fill in the date in paragraph 1 for the applicable assessment year and the county and state where the claims are located.
3. All claim names, BLM serial numbers, legal descriptions, and original county recording information must be listed for the claims pertaining to this assessment notice.
4. The claimant(s) must complete paragraph 2 listing all labor or improvements which was performed on or did benefit the subject mining claims. The value and date of the labor or improvements must also be listed. The total amount of labor or improvements can be listed, but the total expenditure must equal at least \$100 for each claim.
5. The names and current mailing addresses of the person(s) performing the labor shall be listed in paragraph 3.
6. The name and current mailing address of each owner (claimant) of the claims shall be listed in paragraph 4. The mailing address shall be the owner's address and not the address of an agent or anyone representing the claimant. Be sure to note if there has been a change of address.
7. Paragraph 5 shall be completed to show the date it was verified that all monuments required by law were properly erected, all notices were posted, and that corners were appropriately designated for all claims listed.
8. An exact legible reproduction or duplicate (other than microfilm or other electronic media) of this affidavit or another type of affidavit of assessment work that you file or will file in the county where each claim is located, must be filed with the BLM on or before December 30 of the calendar year in which the assessment year ends. For mill or tunnel sites, a separate notice of intent to hold must be filed with the BLM on or before December 30. Requirements for filing a notice of intent to hold can be found at 43 CFR 3835.33.
9. A processing fee of \$10 for each claim listed must be remitted to the BLM along with this or any other affidavit of assessment work.

RECEIVED
BLM AZ
TALAHUE
2018 SEP - 5
PHOENIX, ARIZONA

A notary public or other officer completing this certificate verifies only the identity of the individual who signed the document to which this certificate is attached, and not the truthfulness, accuracy, or validity of that document.

State of California)
County of Lake)

Subscribed and sworn to (or affirmed) before me on this 26th day
of August, 2018, by Ronald Posey

proved to me on the basis of satisfactory evidence to be the person(s)
who appeared before me.

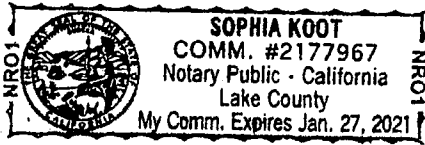

(Seal)

Signature Sophia Koot

RECEIVED
BLM AZ STATE OFF
2018 SEP - 5 P 2: 17
PHOENIX, ARIZON

Optional Information

Although the information in this section is not required by law, it could prevent fraudulent removal and reattachment of this certificate to an unattached document and may prove useful to persons relying on the attached document.

Description of Attached Document

This certificate is attached to a document titled/for the purpose of

Annual Assessment Work
Ronald Posey

containing 3 pages, and dated _____

Additional Information	
Method of Affiant Identification	
Proved to me on the basis of satisfactory evidence: <input checked="" type="radio"/> form(s) of identification <input type="radio"/> credible witness(es)	
Notarial event is detailed in notary journal on: Page # _____ Entry # _____	
Notary contact: _____	
Other	
<input checked="" type="checkbox"/> Affiant(s) Thumbprint(s) <input type="checkbox"/> Describe: _____	
	

UNITED STATES
DEPARTMENT OF THE INTERIOR
BUREAU OF LAND MANAGEMENT

FORM APPROVED
OMB NO.: 1004-0114
Expires: January 31, 2020

AFFIDAVIT OF ANNUAL ASSESSMENT WORK

WHEN RECORDED, MAIL DOCUMENT TO:

NAME: RONALD POSEY

ADDRESS: 4598 HAWAINA WAY

CITY, STATE, ZIP: KELSEYVILLE, CA 95451

FOR COUNTY RECORDER'S USE

No. of Claims 5

x \$10/claim

Total due BLM \$ 50.00

TO ALL WHOM IT MAY CONCERN:

1. The undersigned certifies that at least \$100 per claim was expended for development, labor and improvements, or equivalent value added, as the annual assessment work for the assessment year ending September 1, 2018 for the following contiguous unpatented mining claim(s), located in the County of YAVAPAI, in the State of ARIZONA.

BLM Serial No.	Name of Claim	Tp	Rg	Sec	Mer	County Recordation Book and Page No.	Co. Recording Date
AMC427434	Stockmyer North	9N	5W	25	GSR	2014-0009161	2/26/2014
AMC427435	Stockmyer North Ext	9N	5W	25	GSR	2014-0009162	2/26/2014
AMC427436	Stockmyer South	9N	5W	25	GSR	2014-0009163	2/26/2014
AMC427437	Stockmyer South Ext	9N	5W	25	GSR	2014-0009164	2/26/2014
AMC434563	Gold Bend	9N	5W	24	GSR	2016-003582	4/26/2016

PHOENIX, ARIZONA
 RECEIVED
 BLM AT STATE OFFICE
 SEP - 5 P 2: 26

2. Type of labor and improvements (specify what was done and give the total value for that labor and improvement to show at least \$100 for each claim). If a geological, geochemical, or geophysical survey was performed, as per 30 U.S.C. 28-1, reference the title of the report of survey, give cost and date of the survey and report, and indicate it was filed with the County Recorder:

Description of Work Performed	Value of Work Performed	Date Work Was Performed
CLAIMS IMPROVEMENT	580.00	2017 - 2018

3. Name and mailing address of each person who performed the labor and improvements:

Name (please print)
RONALD POSEY

Current Mailing Address (please print)

4598 HAWAIIA WAY KELSEYVILLE, CA 95451

RECEIVED
 BLM AZ STATE OFFICE
 2018 SEP - 5 P 2: 26
 PHOENIX, ARIZONA

4. Name and mailing address of each person who holds and claims the subject mining claim(s) for the valuable minerals contained therein. Be sure to indicate if there is a change of address:

Name (please print)
RONALD POSEY

Current Mailing Address (please print)

4598 HAWAIIA WAY KELSEYVILLE, CA 95451

MARY POSEY

4598 HAWAIIA WAY KELSEYVILLE, CA 95451

5. The undersigned testifies that on the date of JULY 27, 2018, all monuments required by law were erected upon the subject claim(s), and all notices required by law were posted on the subject claim(s) or copies thereof were in place, and at said date, each corner monument bore or contained

markings sufficient to appropriately designate the corner of the claim to which it pertains and the name of the claim(s).

I hereby certify under penalty of perjury under the laws of the State of ARIZONA that the foregoing statements are true and correct:

Ronald Posey

(Signature of person responsible for above statement)

Date: Aug 26, 2018

Title 18 U.S.C. 1001 and 43 U.S.C. 1212 make it a crime for any person knowingly and willfully to make to any department or agency of the United States any false, fictitious or fraudulent statements or representations as to any matter within its jurisdiction.

Notary Block

SUBSCRIBED AND SWORN TO before me, this 26th day of August 2018

By: Aoshua Koot
(Signature of Affiant)

Title: Notary Public

My Commission Expires: JAN. 27th, 2021



INSTRUCTIONS

see attached jurat

1. This is an optional form that may be used to satisfy the requirements for the Bureau of Land Management (BLM) under the provisions of 43 U.S.C. §1744 and 30 U.S.C. §28-28d and the regulations thereunder (43 CFR part 3835). Since local and State laws may vary, you should contact your local and State agencies where the claims are located to ensure all applicable laws and requirements are satisfied.
2. The claimant(s) must fill in the date in paragraph 1 for the applicable assessment year and the county and state where the claims are located.
3. All claim names, BLM serial numbers, legal descriptions, and original county recording information must be listed for the claims pertaining to this assessment notice.
4. The claimant(s) must complete paragraph 2 listing all labor or improvements which was performed on or did benefit the subject mining claims. The value and date of the labor or improvements must also be listed. The total amount of labor or improvements can be listed, but the total expenditure must equal at least \$100 for each claim.
5. The names and current mailing addresses of the person(s) performing the labor shall be listed on paragraph 3.
6. The name and current mailing address of each owner (claimant) of the claims shall be listed in paragraph 4. The mailing address shall be the owner's address and not the address of an agent or anyone representing the claimant. Be sure to note if there has been a change of address.
7. Paragraph 5 shall be completed to show the date it was verified that all monuments required by law were properly erected, all notices were posted, and that corners were appropriately designated for all claims listed.
8. An exact legible reproduction or duplicate (other than microfilm or other electronic media) of this affidavit or another type of affidavit of assessment work that you file or will file in the county where each claim is located, must be filed with the BLM on or before December 30 of the calendar year in which the assessment year ends. For mill or tunnel sites, a separate notice of intent to hold must be filed with the BLM on or before December 30. Requirements for filing a notice of intent to hold can be found at 43 CFR 3835.33.
9. A processing fee of \$10 for each claim listed must be remitted to the BLM along with this or any other affidavit of assessment work.

A notary public or other officer completing this certificate verifies only the identity of the individual who signed the document to which this certificate is attached, and not the truthfulness, accuracy, or validity of that document.

State of California)
County of Lake)

Subscribed and sworn to (or affirmed) before me on this 26th day
of August, 2018, by Ronald Posey

proved to me on the basis of satisfactory evidence to be the person(s)
who appeared before me.

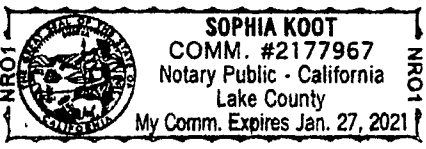

(Seal)

Signature Sophia Koot

RECEIVED
BLM AZ STATE OFFICE
2018 SEP -5 P 2:22
PHOENIX, ARIZONA

Optional Information

Although the information in this section is not required by law, it could prevent fraudulent removal and reattachment of this not to an unauthored document and may prove useful to persons relying on the attached document.

Description of Attached Document

This certificate is attached to a document titled/for the purpose of
Annual Assessment Work
Ronald Posey

containing 3 pages, and dated _____

Additional Information

Method of Affiant Identification

Proved to me on the basis of satisfactory evidence:
 form(s) of identification credible witness(es)

Notarial event is detailed in notary journal on:
 Page # _____ Entry # _____

Notary contact: _____

Other

Affiant(s) Thumbprint(s) Describe: _____



UNITED STATES
DEPARTMENT OF THE INTERIOR
BUREAU OF LAND MANAGEMENT

589

FORM APPROVED
OMB NO.: 1004-0114
Expires: January 31, 2020

AFFIDAVIT OF ANNUAL ASSESSMENT WORK

WHEN RECORDED, MAIL DOCUMENT TO:

NAME: Ronald Posey

ADDRESS: 4598 Hawaina Way

CITY, STATE, ZIP: Kelseyville, CA 95451

FOR COUNTY RECORDER'S USE

No. of Claims 2

x \$10/claim

Total due BLM \$ 20.00

TO ALL WHOM IT MAY CONCERN:

1. The undersigned certifies that at least \$100 per claim was expended for development, labor and improvements, or equivalent value added, as the annual assessment work for the assessment year ending September 1, 2018 for the following contiguous unpatented mining claim(s), located in the County of YAVAPAI, in the State of ARIZONA.

BLM Serial No.	Name of Claim	Tp	Rg	Sec	Mer	County Recordation Book and Page No.	Co. Recording Date
AMC433892	FINE GOLD	9N	5W	24	GSR	2015-0053492	11/09/2015
AMC435529	GOLD HEAD	9N	5W	24	GSR	2016-0005171	02/03/2016

RECEIVED
 BLM AZ STATE OFFICE
 2018 SEP - 5 P 2: 25
 PHOENIX, ARIZONA

2. Type of labor and improvements (specify what was done and give the total value for that labor and improvement to show at least \$100 for each claim). If a geological, geochemical, or geophysical survey was performed, as per 30 U.S.C. 28-1, reference the title of the report of survey, give cost and date of the survey and report, and indicate it was filed with the County Recorder:

Description of Work Performed	Value of Work Performed	Date Work Was Performed
CLAIMS IMPROVEMENT	325.00	2017-2018

3. Name and mailing address of each person who performed the labor and improvements:

Name (please print)
RONALD POSEY

WALTER POSEY

DENNIS RADONICH

RICHARD RADONICH

Current Mailing Address (please print)
4598 Hawaina Way Kelseyville, CA 95451

P.O. BOX 95 SAN LEANDRO, CA 94577

13165 MONTECITO RD. RED BLUFF, CA 96080

14720 MOLLUC DR. RED BLUFF, CA 96080

4. Name and mailing address of each person who holds and claims the subject mining claim(s) for the valuable minerals contained therein. Be sure to indicate if there is a change of address:

Name (please print)
RONALD POSEY

WALTER POSEY

DENNIS RADONICH

RICHARD RADONICH

Current Mailing Address (please print)

4598 HAWAINA WAY KELSEYVILLE, CA 95451

P.O. BOX 95 SAN LEANDRO, CA 94577

13165 MONTECITO RD. RED BLUFF, CA 96080

14720 MOLLUC DR. RED BLUFF, CA 96080

RECEIVED
 BLM
 AZ STATE OFFICE
 PHOENIX, ARIZONA
 SEP - 5 P 2: 25

5. The undersigned testifies that on the date of JULY 27, 2018, all monuments required by law were erected upon the subject claim(s), and all notices required by law were posted on the subject claim(s) or copies thereof were in place, and at said date, each corner monument bore or contained

markings sufficient to appropriately designate the corner of the claim to which it pertains and the name of the claim(s).

I hereby certify under penalty of perjury under the laws of the State of ARIZONA that the foregoing statements are true and correct:

Ronald Posey
(Signature of person responsible for above statement)

Date: Aug 26, 2018

Title 18 U.S.C. 1001 and 43 U.S.C. 1212 make it a crime for any person knowingly and willfully to make to any department or agency of the United States any false, fictitious or fraudulent statements or representations as to any matter within its jurisdiction.

Notary Block

SUBSCRIBED AND SWORN TO before me, this 26th day of August 2018

By: Sophia Koot
(Signature of Affiant)

Title: NOTARY public

My Commission Expires: JAN. 27th, 2021

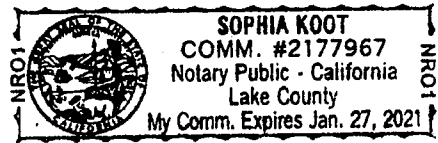

INSTRUCTIONS

see attached JURAT.

1. This is an optional form that may be used to satisfy the requirements for the Bureau of Land Management (BLM) under the provisions of 43 U.S.C. §1744 and 30 U.S.C. §28-28d and the regulations thereunder (43 CFR part 3835). Since local and State laws may vary, you should contact your local and State agencies where the claims are located to ensure all applicable laws and requirements are satisfied.
2. The claimant(s) must fill in the date in paragraph 1 for the applicable assessment year and the county and state where the claims are located.
3. All claim names, BLM serial numbers, legal descriptions, and original county recording information must be listed for the claims pertaining to this assessment notice.
4. The claimant(s) must complete paragraph 2 listing all labor or improvements which was performed on or did benefit the subject mining claims. The value and date of the labor or improvements must also be listed. The total amount of labor or improvements can be listed, but the total expenditure must equal at least \$100 for each claim.
5. The names and current mailing addresses of the person(s) performing the labor shall be listed in paragraph 4.
6. The name and current mailing address of each owner (claimant) of the claims shall be listed in paragraph 4. The mailing address shall be the owner's address and not the address of an agent or anyone representing the claimant. Be sure to note if there has been a change of address.
7. Paragraph 5 shall be completed to show the date it was verified that all monuments required by law were properly erected, all notices were posted, and that corners were appropriately designated for all claims listed.
8. An exact legible reproduction or duplicate (other than microfilm or other electronic media) of this affidavit or another type of affidavit of assessment work that you file or will file in the county where each claim is located, must be filed with the BLM on or before December 30 of the calendar year in which the assessment year ends. For mill or tunnel sites, a separate notice of intent to hold must be filed with the BLM on or before December 30. Requirements for filing a notice of intent to hold can be found at 43 CFR 3835.33.
9. A processing fee of \$10 for each claim listed must be remitted to the BLM along with this or any other affidavit of assessment work.

PHONIX ARIZONA
SEP 2 25
BLM
RECEIVED
FBI

A notary public or other officer completing this certificate verifies only the identity of the individual who signed the document to which this certificate is attached, and not the truthfulness, accuracy, or validity of that document.

State of California)
County of Lake)

Subscribed and sworn to (or affirmed) before me on this 26th day
of August, 2018, by Ronald Posey ^{SK}

proved to me on the basis of satisfactory evidence to be the person(s)
who appeared before me.



(Seal)

Signature Sophia Koot

RECEIVED
BLM
AZ STATE OFFICE
PHOENIX, ARIZONA
SEP - 5 P 2:25

Optional Information

Although the information in this section is not required by law, it could prevent fraudulent removal and reattachment of this part to an unauthorized document and may prove useful to persons relying on the attached document.

Description of Attached Document

This certificate is attached to a document titled/for the purpose of

Annual Assessment Work
Ronald Posey

containing 3 pages, and dated _____

Additional Information

Method of Affiant Identification

Proved to me on the basis of satisfactory evidence:
 form(s) of identification credible witness(es)

Notarial event is detailed in notary journal on:
 Page # _____ Entry # _____

Notary contact: _____

Other

Affiant(s) Thumbprint(s) Describe: _____



RECEIVED
BLM AZ STATE OFFICE

2018 SEP -5 P 2:26

PHOENIX, ARIZONA

BLM
ARIZONA STATE OFFICE

Ronald Posey
4598 Hawaina Way
Kelseyville, CA 95451-9756

RECEIVED
BLM AZ STATE OFFICE

2010 SEP -5 P 2:27

PHOENIX, ARIZONA

BLM
ARIZONA STATE OFFICE



Ronald Posey
4598 Hawaina Way
Kelseyville, CA 95451-9756

 **Ronald Posey**
4598 Hawaina Way
Kelseyville, CA 95451-9756

\$5.08⁰
US POSTAGE
FIRST-CLASS
San Francisco, CA 941
Friday Aug 31, 2018
071V01042979
85461
000006095

U.S. DEPARTMENT OF THE INTERIOR
BUREAU OF LAND MANAGEMENT
ARIZONA STATE OFFICE
ONE NORTH CENTRAL AVE. SUITE 800
PHOENIX, ARIZONA 85004-4427

PLACE STICKER AT TOP OF ENVELOPE TO THE RIGHT
OF THE RETURN ADDRESS, FOLDED AT DOTTED LINE

CERTIFIED MAIL



7017 3040 0000 2102 42ED 4682 0000 7894 0374

RECEIVED
BLM AZ STATE OFFICE
2018 SEP - 5 P 2:25
PHOENIX, ARIZONA

United States Department of the Interior
Bureau of Land Management
 DIV OF LANDS, MINRLS & ENERGY
 ONE N CENTRAL AVE
 PHOENIX, AZ 85004 -4427
 Phone: 602-417-9200

Receipt

No: 4260036

Transaction #: 4375642	
Date of Transaction: 09/11/2018	
CUSTOMER:	
RONALD POSEY 4598 HAWAINA WAY KELSEYVILLE,CA 95451-9756 US	

LINE #	QTY	DESCRIPTION	REMARKS	UNIT PRICE	TOTAL
1	1.00	LOCATABLE MINERALS / MINING CLAIMS-NOT NEW-UNADJUD,ONE AUTH NO. ONLY / MINING CLAIM MONEY RECEIVED CASES: AMC426221/\$80.00	POL 2018/8	- n/a -	80.00
TOTAL:					\$80.00

PAYMENT INFORMATION					
1	AMOUNT:	10.00	POSTMARKED:	N/A	
	TYPE:	CHECK	RECEIVED:	09/05/2018	
	CHECK NO:	3961			
	NAME:	POSEY, RONALD 4598 HAWAINA WAY KELSEYVILLE CA 95451-9756 US			
2	AMOUNT:	50.00	POSTMARKED:	N/A	
	TYPE:	CHECK	RECEIVED:	09/05/2018	
	CHECK NO:	3962			
	NAME:	POSEY, RONALD 4598 HAWAINA WAY KELSEYVILLE CA 95451-9756 US			
3	AMOUNT:	20.00	POSTMARKED:	N/A	
	TYPE:	CHECK	RECEIVED:	09/05/2018	
	CHECK NO:	3963			
	NAME:	POSEY, RONALD 4598 HAWAINA WAY KELSEYVILLE CA 95451-9756 US			

REMARKS

584

427434
434363

UNITED STATES
DEPARTMENT OF THE INTERIOR
BUREAU OF LAND MANAGEMENT

MAINTENANCE FEE WAIVER CERTIFICATION

FORM APPROVED
OMB NO. 1004-0114
Expires: January 31, 2020

SEE INSTRUCTIONS ON PAGE 2

- This small miner waiver is filed for the assessment year beginning on September 1, 2018 and ending on September 1, 2019.
- The undersigned and all related parties owned ten or fewer mining claims, mill, or tunnel sites located and maintained on Federal lands in the United States of America on September 1, 2018.
- The undersigned have performed the assessment work required by law for each mining claim listed prior to filing this waiver and understand that by filing this form, the undersigned must file an affidavit of assessment work with the Bureau of Land Management (BLM) by the December 30th following the filing of this waiver.
- The undersigned understand that if the assessment work obligation has not yet come due under 30 U.S.C. 28 (for those claims in their first assessment year only), a notice of intent to hold reciting this condition must be recorded by the December 30th following the filing of this waiver.
- The undersigned understand that mill and tunnel sites may also be listed on this waiver and be waived from payment of the maintenance fee, and that a notice of intent to hold for these sites is required to be filed with the BLM by the December 30th following the filing of this waiver.
- The undersigned understand and acknowledge that pursuant to 43 U.S.C. 1212 and 18 U.S.C. 1001, the filing or recording of a false, fictitious, or fraudulent document with the BLM may result in a fine of up to \$250,000, a prison term not to exceed five years, or both.
- The mining claims, mill or tunnel sites for which this waiver from payment of the maintenance fees is requested are:

CLAIM OR SITE NAME	BLM RECORDATION SERIAL NUMBER
1. STOCKMYER NORTH	AMC427434
2. STOCKMYER NORTH EXT.	AMC427435
3. STOCKMYER SOUTH	AMC427436
4. STOCKMYER SOUTH EXT.	AMC427437
5. GOLD BEND	AMC434563
6.	
7.	
8.	
9.	
10.	

RECEIVED
BLM AZ STATE OFFICE
2018 SEP -5 P 2:26
PHOENIX, ARIZONA

The owner(s) (claimants) of the above mining claims and sites are:

RONALD POSEY
(Owner's Name - Please Print)

4598 HAWAINA WAY
(Owner's Mailing Address)

KELSEYVILLE CA 95451
(City) (State) (Zip Code)

Ronald Posey
(Owner's Signature)

MARY POSEY
(Owner's Name - Please Print)

4598 HAWAINA WAY
(Owner's Mailing Address)

KELSEYVILLE CA 95451
(City) (State) (Zip Code)

Mary Posey
(Owner's Signature)

(Owner's Name - Please Print)

(Owner's Mailing Address)

(City) (State) (Zip Code)

(Owner's Name - Please Print)

(Owner's Mailing Address)

(City) (State) (Zip Code)

ENTERED
SEP 20 2018
BY: JDS



Ronald Posey
4598 Hawaina Way
Kelseyville, CA 95451-9756

BLM
ARIZONA STATE OFFICE

RECEIVED
BLM AZ STATE OFFICE
2010 SEP -5 P 2:25
PHOENIX, ARIZONA

UNITED STATES
DEPARTMENT OF THE INTERIOR
BUREAU OF LAND MANAGEMENT

FORM APPROVED
OMB NO.: 1004-0114
Expires: January 31, 2020

AFFIDAVIT OF ANNUAL ASSESSMENT WORK

433892

WHEN RECORDED, MAIL DOCUMENT TO:

NAME: RONALD POSEY

ADDRESS: 4598 HAWAINA WAY

CITY, STATE, ZIP: KELSEYVILLE, CA 95451

435529

427434

434563

426220

FOR COUNTY RECORDER'S USE

No. of Claims 2

x \$10/claim

Total due BLM \$ 20.00

TO ALL WHOM IT MAY CONCERN:

- The undersigned certifies that at least \$100 per claim was expended for development, labor and improvements, or equivalent value added, as the annual assessment work for the assessment year ending September 1, 2017 for the following contiguous unpatented mining claim(s), located in the County of YAVAPAI, in the State of ARIZONA.

BLM Serial No.	Name of Claim	Tp Rg Sec Mer				County Recordation Book and Page No.	Co. Recording Date
		Example: 13N 5E 14 MDM					
AMC433892	FINE GOLD	9N	5W	24	GSR	2015-0053492	11/09/2015
AMC435529	GOLD HEAD	9N	5W	24	GSR	2016-0005171	02/03/2016

RECEIVED
BLM AZ STATE OFFICE
2017 AUG 23 A 9 16
PHOENIX ARIZONA

395470 /

ENTERED
AUG 29 2017
BY: RAM

2. Type of labor and improvements (specify what was done and give the total value for that labor and improvement to show at least \$100 for each claim). If a geological, geochemical, or geophysical survey was performed, as per 30 U.S.C. 28-1, reference the title of the report of survey, give cost and date of the survey and report, and indicate it was filed with the County Recorder:

Description of Work Performed	Value of Work Performed	Date Work Was Performed
CLAIM IMPROVEMENT	280.00	2016-2017

3. Name and mailing address of each person who performed the labor and improvements:

Name (please print)

RONALD POSEY

WALTER POSEY

DENNIS RADONICH

RICHARD RADONICH

Current Mailing Address (please print)

4598 HAWAINA WAY KELSEYVILLE, CA 95451

3818 AQUA VISTA OAKLAND, CA 94601

13165 MONTECITO RD. RED BLUFF, CA 96080

14720 MOLLUC DR. RED BLUFF, CA 96080

4. Name and mailing address of each person who holds and claims the subject mining claim(s) for the valuable minerals contained therein. Be sure to indicate if there is a change of address:

Name (please print)

RONALD POSEY

WALTER POSEY

DENNIS RADONICH

RICHARD RADONICH

Current Mailing Address (please print)

4598 HAWAINA WAY KELSEYVILLE, CA 95451

3818 AQUA VISTA OAKLAND, CA 94601

13165 MONTECITO RD. RED BLUFF, CA 96080

14720 MOLLUC DR. RED BLUFF, CA 96080

RECEIVED
 BLM STATE OFFICE
 2017 AUG 23 A 9:16
 PHOENIX, ARIZONA

5. The undersigned testifies that on the date of MAY 22, 2017, all monuments required by law were erected upon the subject claim(s), and all notices required by law were posted on the subject claim(s) or copies thereof were in place, and at said date, each corner monument bore or contained

markings sufficient to appropriately designate the corner of the claim to which it pertains and the name of the claim(s).

I hereby certify under penalty of perjury under the laws of the State of ARIZONA that the foregoing statements are true and correct:

Ronald Posey

Date: 8/18/17

(Signature of person responsible for above statement)

Title 18 U.S.C. 1001 and 43 U.S.C. 1212 make it a crime for any person knowingly and willfully to make to any department or agency of the United States any false, fictitious or fraudulent statements or representations as to any matter within its jurisdiction.

Notary Block

SUBSCRIBED AND SWORN TO before me, this _____ day of _____ 20____

By: See Attached Certificate
(Signature of Affiant)

Title: _____

My Commission Expires: _____

RECEIVED
BLM AZ STATE OFFICE
2017 AUG 23 A 9:10
PHOENIX, ARIZONA

INSTRUCTIONS

1. This is an optional form that may be used to satisfy the requirements for the Bureau of Land Management (BLM) under the provisions of 43 U.S.C. §1744 and 30 U.S.C. §28-28d and the regulations thereunder (43 CFR part 3835). Since local and State laws may vary, you should contact your local and State agencies where the claims are located to ensure all applicable laws and requirements are satisfied.
2. The claimant(s) must fill in the date in paragraph 1 for the applicable assessment year and the county and state where the claims are located.
3. All claim names, BLM serial numbers, legal descriptions, and original county recording information must be listed for the claims pertaining to this assessment notice.
4. The claimant(s) must complete paragraph 2 listing all labor or improvements which was performed on or did benefit the subject mining claims. The value and date of the labor or improvements must also be listed. The total amount of labor or improvements can be listed, but the total expenditure must equal at least \$100 for each claim.
5. The names and current mailing addresses of the person(s) performing the labor shall be listed in paragraph 3.
6. The name and current mailing address of each owner (claimant) of the claims shall be listed in paragraph 4. The mailing address shall be the owner's address and not the address of an agent or anyone representing the claimant. Be sure to note if there has been a change of address.
7. Paragraph 5 shall be completed to show the date it was verified that all monuments required by law were properly erected, all notices were posted, and that corners were appropriately designated for all claims listed.
8. An exact legible reproduction or duplicate (other than microfilm or other electronic media) of this affidavit or another type of affidavit of assessment work that you file or will file in the county where each claim is located, must be filed with the BLM on or before December 30 of the calendar year in which the assessment year ends. For mill or tunnel sites, a separate notice of intent to hold must be filed with the BLM on or before December 30. Requirements for filing a notice of intent to hold can be found at 43 CFR 3835.33.
9. A processing fee of \$10 for each claim listed must be remitted to the BLM along with this or any other affidavit of assessment work.

UNITED STATES
DEPARTMENT OF THE INTERIOR
BUREAU OF LAND MANAGEMENT

AFFIDAVIT OF ANNUAL ASSESSMENT WORK

WHEN RECORDED, MAIL DOCUMENT TO:

NAME: Ronald Posey

ADDRESS: 4598 Hawaina Way

CITY, STATE, ZIP: Kelseyville, CA 95451

FOR COUNTY RECORDER'S USE

No. of Claims 4

x \$10/claim

Total due BLM \$ 40.00

TO ALL WHOM IT MAY CONCERN:

- The undersigned certifies that at least \$100 per claim was expended for development, labor and improvements, or equivalent value added, as the annual assessment work for the assessment year ending September 1, 2017 for the following contiguous unpatented mining claim(s), located in the County of YAVAPAI, in the State of ARIZONA.

BLM Serial No.	Name of Claim	Tp	Rg	Sec	Mer	County Recordation Book and Page No.	Co. Recording Date
AMC427434	STOCKMYER NORTH	9N	5W	25	GSR	2014-0009161	2/26/2014
AMC427435	STOCKMYER NORTH EXT.	9N	5W	25	GSR	2014-0009162	2/26/2014
AMC427436	STOCKMYER SOUTH	9N	5W	25	GSR	2014-0009163	2/26/2014
AMC427437	STOCKMYER SOUTH EXT.	9N	5W	25	GSR	2014-0009164	2/26/2014

RECEIVED
 BLM STATE OFFICE
 2017 AUG 23 A 9 14
 PHOENIX, ARIZONA

2. Type of labor and improvements (specify what was done and give the total value for that labor and improvement to show at least \$100 for each claim). If a geological, geochemical, or geophysical survey was performed, as per 30 U.S.C. 28-1, reference the title of the report of survey, give cost and date of the survey and report, and indicate it was filed with the County Recorder:

Description of Work Performed	Value of Work Performed	Date Work Was Performed
CLAIM IMPROVEMENTS	479.00	2016 - 2017

3. Name and mailing address of each person who performed the labor and improvements:

Name (please print)
 RONALD POSEY

Current Mailing Address (please print)
 4598 HAWAINA WAY KELSEYVILLE, CA 95451

4. Name and mailing address of each person who holds and claims the subject mining claim(s) for the valuable minerals contained therein. Be sure to indicate if there is a change of address:

Name (please print)
 RONALD POSEY
 MARY POSEY

Current Mailing Address (please print)
 4598 HAWAINA WAY KELSEYVILLE, CA 95451
 4598 HAWAINA WAY KELSEYVILLE, CA 95451

5. The undersigned testifies that on the date of MAY 22, 2016, all monuments required by law were erected upon the subject claim(s), and all notices required by law were posted on the subject claim(s) or copies thereof were in place, and at said date, each corner monument bore or contained

RECEIVED
 BLM AZ STATE OFFICE
 2017 AUG 23 9 14
 PHOENIX, ARIZONA

markings sufficient to appropriately designate the corner of the claim to which it pertains and the name of the claim(s).

I hereby certify under penalty of perjury under the laws of the State of ARIZONA that the foregoing statements are true and correct:

Revelo Pesea Date: 8/18/2017
(Signature of person responsible for above statement)

Title 18 U.S.C. 1001 and 43 U.S.C. 1212 make it a crime for any person knowingly and willfully to make to any department or agency of the United States any false, fictitious or fraudulent statements or representations as to any matter within its jurisdiction.

Notary Block

SUBSCRIBED AND SWORN TO before me, this _____ day of _____ 20____

By: See Attached Certificate
(Signature of Affiant)

Title: _____

My Commission Expires: _____

RECEIVED
BLM AZ STATE OFFICE
2011 AUG 23 A 9:14
PHOENIX, ARIZONA

INSTRUCTIONS

1. This is an optional form that may be used to satisfy the requirements for the Bureau of Land Management (BLM) under the provisions of 43 U.S.C. §1744 and 30 U.S.C. §28-28d and the regulations thereunder (43 CFR part 3835). Since local and State laws may vary, you should contact your local and State agencies where the claims are located to ensure all applicable laws and requirements are satisfied.
2. The claimant(s) must fill in the date in paragraph 1 for the applicable assessment year and the county and state where the claims are located.
3. All claim names, BLM serial numbers, legal descriptions, and original county recording information must be listed for the claims pertaining to this assessment notice.
4. The claimant(s) must complete paragraph 2 listing all labor or improvements which was performed on or did benefit the subject mining claims. The value and date of the labor or improvements must also be listed. The total amount of labor or improvements can be listed, but the total expenditure must equal at least \$100 for each claim.
5. The names and current mailing addresses of the person(s) performing the labor shall be listed in paragraph 3.
6. The name and current mailing address of each owner (claimant) of the claims shall be listed in paragraph 4. The mailing address shall be the owner's address and not the address of an agent or anyone representing the claimant. Be sure to note if there has been a change of address.
7. Paragraph 5 shall be completed to show the date it was verified that all monuments required by law were properly erected, all notices were posted, and that corners were appropriately designated for all claims listed.
8. An exact legible reproduction or duplicate (other than microfilm or other electronic media) of this affidavit or another type of affidavit of assessment work that you file or will file in the county where each claim is located, must be filed with the BLM on or before December 30 of the calendar year in which the assessment year ends. For mill or tunnel sites, a separate notice of intent to hold must be filed with the BLM on or before December 30. Requirements for filing a notice of intent to hold can be found at 43 CFR 3835.33.
9. A processing fee of \$10 for each claim listed must be remitted to the BLM along with this or any other affidavit of assessment work.

UNITED STATES
DEPARTMENT OF THE INTERIOR
BUREAU OF LAND MANAGEMENT

FORM APPROVED
OMB NO.: 1004-0114
Expires: January 31, 2020

AFFIDAVIT OF ANNUAL ASSESSMENT WORK

WHEN RECORDED, MAIL DOCUMENT TO:

NAME: RONALD POSEY

ADDRESS: 4598 HAWAINA WAY

CITY, STATE, ZIP: KELSEYVILLE, CA 95451

FOR COUNTY RECORDER'S USE

No. of Claims 1

x \$10/claim

Total due BLM \$ 10.00

TO ALL WHOM IT MAY CONCERN:

- The undersigned certifies that at least \$100 per claim was expended for development, labor and improvements, or equivalent value added, as the annual assessment work for the assessment year ending September 1, 2017 for the following contiguous unpatented mining claim(s), located in the County of YAVAPAI, in the State of ARIZONA.

BLM Serial No.	Name of Claim	Tp Rg Sec Mer				County Recordation Book and Page No.	Co. Recording Date
		Example: 13N 5E 14 MDM					
AMC434563	GOLD BEND	9N	5W	24	GSR	2016-0015825	04/06/2016

RECEIVED
 BLM AT STATE OFFICE
 PHOENIX, ARIZONA
 2017 AUG 23 A 9:15

2. Type of labor and improvements (specify what was done and give the total value for that labor and improvement to show at least \$100 for each claim). If a geological, geochemical, or geophysical survey was performed, as per 30 U.S.C. 28-1, reference the title of the report of survey, give cost and date of the survey and report, and indicate it was filed with the County Recorder:

Description of Work Performed	Value of Work Performed	Date Work Was Performed
CLAIM IMPROVEMENT	220.00	2016 - 2017

3. Name and mailing address of each person who performed the labor and improvements:

Name (please print)
RONALD POSEY

Current Mailing Address (please print)
4598 HAWAINA WAY KELSEYVILLE, CA 95451

4. Name and mailing address of each person who holds and claims the subject mining claim(s) for the valuable minerals contained therein. Be sure to indicate if there is a change of address:

Name (please print)
RONALD POSEY

Current Mailing Address (please print)
4598 HAWAINA WAY KELSEYVILLE, CA 95451

MARY POSEY

4598 HAWAINA WAY KELSEYVILLE, CA 95451

RECEIVED
 BLM AZ STATE OFFICE
 2011 AUG 23 A 9 15
 PHOENIX, ARIZONA

5. The undersigned testifies that on the date of MAY 22, 2011, all monuments required by law were erected upon the subject claim(s), and all notices required by law were posted on the subject claim(s) or copies thereof were in place, and at said date, each corner monument bore or contained

markings sufficient to appropriately designate the corner of the claim to which it pertains and the name of the claim(s).

I hereby certify under penalty of perjury under the laws of the State of ARIZONA that the foregoing statements are true and correct:

Ronald Rosey

Date: 8/18/17

(Signature of person responsible for above statement)

Title 18 U.S.C. 1001 and 43 U.S.C. 1212 make it a crime for any person knowingly and willfully to make to any department or agency of the United States any false, fictitious or fraudulent statements or representations as to any matter within its jurisdiction.

Notary Block

SUBSCRIBED AND SWORN TO before me, this _____ day of _____ 20____

By: See Attached Certificate
(Signature of Affiant)

Title: _____

My Commission Expires: _____

RECEIVED
BLM AZ STATE OFFICE
2011 AUG 23 A 9 15
PHOENIX, ARIZONA

INSTRUCTIONS

1. This is an optional form that may be used to satisfy the requirements for the Bureau of Land Management (BLM) under the provisions of 43 U.S.C. §1744 and 30 U.S.C. §28-28d and the regulations thereunder (43 CFR part 3835). Since local and State laws may vary, you should contact your local and State agencies where the claims are located to ensure all applicable laws and requirements are satisfied.
2. The claimant(s) must fill in the date in paragraph 1 for the applicable assessment year and the county and state where the claims are located.
3. All claim names, BLM serial numbers, legal descriptions, and original county recording information must be listed for the claims pertaining to this assessment notice.
4. The claimant(s) must complete paragraph 2 listing all labor or improvements which was performed on or did benefit the subject mining claims. The value and date of the labor or improvements must also be listed. The total amount of labor or improvements can be listed, but the total expenditure must equal at least \$100 for each claim.
5. The names and current mailing addresses of the person(s) performing the labor shall be listed in paragraph 3.
6. The name and current mailing address of each owner (claimant) of the claims shall be listed in paragraph 4. The mailing address shall be the owner's address and not the address of an agent or anyone representing the claimant. Be sure to note if there has been a change of address.
7. Paragraph 5 shall be completed to show the date it was verified that all monuments required by law were properly erected, all notices were posted, and that corners were appropriately designated for all claims listed.
8. An exact legible reproduction or duplicate (other than microfilm or other electronic media) of this affidavit or another type of affidavit of assessment work that you file or will file in the county where each claim is located, must be filed with the BLM on or before December 30 of the calendar year in which the assessment year ends. For mill or tunnel sites, a separate notice of intent to hold must be filed with the BLM on or before December 30. Requirements for filing a notice of intent to hold can be found at 43 CFR 3835.33.
9. A processing fee of \$10 for each claim listed must be remitted to the BLM along with this or any other affidavit of assessment work.

UNITED STATES
DEPARTMENT OF THE INTERIOR
BUREAU OF LAND MANAGEMENT

FORM APPROVED
OMB NO.: 1004-0114
Expires: January 31, 2020

AFFIDAVIT OF ANNUAL ASSESSMENT WORK

WHEN RECORDED, MAIL DOCUMENT TO:

NAME: RONALD POSEY

ADDRESS: 4598 HAWAINA WAY

CITY, STATE, ZIP: KELSEYVILLE, CA 5451

FOR COUNTY RECORDER'S USE

No. of Claims 1

x \$10/claim

Total due BLM \$ 10.00

TO ALL WHOM IT MAY CONCERN:

- The undersigned certifies that at least \$100 per claim was expended for development, labor and improvements, or equivalent value added, as the annual assessment work for the assessment year ending September 1, 2017 for the following contiguous unpatented mining claim(s), located in the County of YAVAPAI, in the State of ARIZONA.

BLM Serial No.	Name of Claim	Tp	Rg	Sec	Mer	County Recordation Book and Page No.	Co. Recording Date
AMC426221	BETTER THAN NOTHING 2	9N	4W	20	GSR	2014-0003094	12/17/2013

RECEIVED
 BLM AZ STATE OFFICE
 2017 AUG 23 A 9 17
 PHOENIX, ARIZONA

2. Type of labor and improvements (specify what was done and give the total value for that labor and improvement to show at least \$100 for each claim). If a geological, geochemical, or geophysical survey was performed, as per 30 U.S.C. 28-1, reference the title of the report of survey, give cost and date of the survey and report, and indicate it was filed with the County Recorder:

Description of Work Performed	Value of Work Performed	Date Work Was Performed
CLAIM IMPROVEMENT	175.00	2016 - 2017

3. Name and mailing address of each person who performed the labor and improvements:

Name (please print)

RONALD POSEY

WALTER POSEY

Current Mailing Address (please print)

4598 HAWAINA WAY KELSEYVILLE, CA 95451

3818 AQUA VISTA OAKLAND, CA 94601

4. Name and mailing address of each person who holds and claims the subject mining claim(s) for the valuable minerals contained therein. Be sure to indicate if there is a change of address:

Name (please print)

RONALD POSEY

WALTER POSEY

Current Mailing Address (please print)

4598 HAWAINA WAY KELSEYVILLE, CA 95451

3818 AQUA VISTA OAKLAND, CA 94601

5. The undersigned testifies that on the date of MAY 22, 2017, all monuments required by law were erected upon the subject claim(s), and all notices required by law were posted on the subject claim(s) or copies thereof were in place, and at said date, each corner monument bore or contained

RECEIVED
 BLM ARIZONA STATE OFFICE
 2017 AUG 23 A 9:11
 PHOENIX, ARIZONA

markings sufficient to appropriately designate the corner of the claim to which it pertains and the name of the claim(s).

I hereby certify under penalty of perjury under the laws of the State of ARIZONA that the foregoing statements are true and correct:

Ronald Pree

Date: 8/18/17

(Signature of person responsible for above statement)

Title 18 U.S.C. 1001 and 43 U.S.C. 1212 make it a crime for any person knowingly and willfully to make to any department or agency of the United States any false, fictitious or fraudulent statements or representations as to any matter within its jurisdiction.

Notary Block

SUBSCRIBED AND SWORN TO before me, this _____ day of _____ 20____

By: See Attached Certificate
(Signature of Affiant)

Title: _____

My Commission Expires: _____

RECEIVED
BLM AZ STATE OFFICE
2017 AUG 23 A 9 17
PHOENIX, ARIZONA

INSTRUCTIONS

1. This is an optional form that may be used to satisfy the requirements for the Bureau of Land Management (BLM) under the provisions of 43 U.S.C. §1744 and 30 U.S.C. §28-28d and the regulations thereunder (43 CFR part 3835). Since local and State laws may vary, you should contact your local and State agencies where the claims are located to ensure all applicable laws and requirements are satisfied.
2. The claimant(s) must fill in the date in paragraph 1 for the applicable assessment year and the county and state where the claims are located.
3. All claim names, BLM serial numbers, legal descriptions, and original county recording information must be listed for the claims pertaining to this assessment notice.
4. The claimant(s) must complete paragraph 2 listing all labor or improvements which was performed on or did benefit the subject mining claims. The value and date of the labor or improvements must also be listed. The total amount of labor or improvements can be listed, but the total expenditure must equal at least \$100 for each claim.
5. The names and current mailing addresses of the person(s) performing the labor shall be listed in paragraph 3.
6. The name and current mailing address of each owner (claimant) of the claims shall be listed in paragraph 4. The mailing address shall be the owner's address and not the address of an agent or anyone representing the claimant. Be sure to note if there has been a change of address.
7. Paragraph 5 shall be completed to show the date it was verified that all monuments required by law were properly erected, all notices were posted, and that corners were appropriately designated for all claims listed.
8. An exact legible reproduction or duplicate (other than microfilm or other electronic media) of this affidavit or another type of affidavit of assessment work that you file or will file in the county where each claim is located, must be filed with the BLM on or before December 30 of the calendar year in which the assessment year ends. For mill or tunnel sites, a separate notice of intent to hold must be filed with the BLM on or before December 30. Requirements for filing a notice of intent to hold can be found at 43 CFR 3835.33.
9. A processing fee of \$10 for each claim listed must be remitted to the BLM along with this or any other affidavit of assessment work.

RON POSEY
(707) 245-4217
4598 HAWAIIA WAY
KELSEYVILLE CA 95451

1 LB 1 OF 1
SHP W 1 LBS
DATE: 8 AUG 2017

SHIP BLM ARIZONA STATE OFFICE
TO: 1 N CENTRAL AVE

PHOENIX AZ 85004-4414

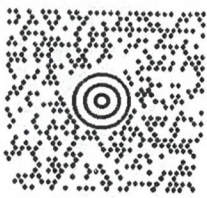

AZ 850 9-10



UPS GROUND

TRACKING #: 1Z A3E 752 03 4149 1615

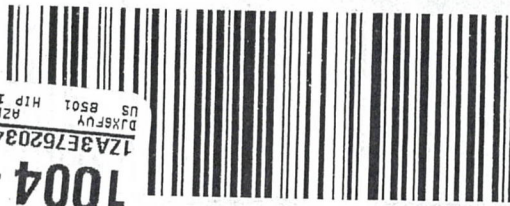

PHOENIX AZ 85004-4414
1 N CENTRAL AVE
BLM ARIZONA STATE OFFICE
P: BROWN S: ORANGE I:
1004-5240
17A3E752034149
DJKSFVY
US 8501 HTP 17.03.03 ZERRAZM400
AUG 22 06:52:44 2017

ISH 13.00N E2844 90.5V 07/2017



SEE NOTICE ON REVERSE regarding UPS Terms, and notice of limitation of liability. Where allowed by law, shipper authorizes UPS to act as forwarding agent for export control and customs purposes. If exported from the US, shipper certifies that the commodities, technology or software were exported from the US in accordance with the Export Administration Regulations. Diversion contrary to law is prohibited. RRD Rf2 0717

PHOENIX, ARIZONA

2017 AUG 23 A 9 13

RECEIVED
BLM STATE OFFICE

RECEIVED
BLM AZ STATE OFFICE

2017 AUG 23 A 9 15

PHOENIX, ARIZONA

BLM Arizona State Office
One North Central Ave.
Suite 800
Phoenix, AZ 85004-4427

Ronald S. Posey
4588 Hawana Way
Keiseyville, CA 95451

RECEIVED
BLM AZ STATE OFFICE

2017 AUG 23 A 9 16

PHOENIX, ARIZONA

Ronald S. Posey
4508 Hawaiian Way
Kelseyville, CA 95451

BLM Arizona State Office
One North Central Ave.
Suite 800
Phoenix, AZ 85004-4427

BLM Arizona State Office
One North Central Ave.
Suite 800
Phoenix, AZ 85004-4427

PHOENIX, ARIZONA

2011 AUG 23 A 9:18

RECEIVED
BLM AZ STATE OFFICE

Ronald S. Posey
4598 Hawaina Way
Keiseyville, CA 95451

RECEIVED
BLM AZ STATE OFFICE

2017 AUG 23 A 9 15

PHOENIX, ARIZONA

BLM Arizona State Office
One North Central Ave.
Suite 800
Phoenix, AZ 85004-4427

Ronald S. Posey
4598 Hawaina Way
Keiseyville, CA 95451

United States Department of the Interior
Bureau of Land Management
 DIV OF LANDS, MINRLS & ENERGY
 ONE N CENTRAL AVE
 PHOENIX, AZ 85004 -4427
 Phone: 602-417-9200

Receipt

No: 3954701

Transaction #: 4064457	
Date of Transaction: 08/24/2017	
CUSTOMER:	
RONALD POSEY 4598 HAWAINA WAY KELSEYVILLE, CA 95451-9756 US	

LINE #	QTY	DESCRIPTION	REMARKS	UNIT PRICE	TOTAL
1	1.00	LOCATABLE MINERALS / MINING CLAIMS- NOT NEW-UNADJUD, ONE AUTH NO. ONLY / MINING CLAIM MONEY RECEIVED CASES: AMC433892/\$80.00	POL 2017/8 WAV	- n/a -	80.00
TOTAL:					\$80.00

PAYMENT INFORMATION					
1	AMOUNT:	20.00	POSTMARKED:	08/22/2017	
	TYPE:	CHECK	RECEIVED:	08/23/2017	
	CHECK NO:	3809			
	NAME:	POSEY, RON 4598 HAWAINA WAY KELSEYVILLE CA 95451-9756 US			
2	AMOUNT:	40.00	POSTMARKED:	08/22/2017	
	TYPE:	CHECK	RECEIVED:	08/23/2017	
	CHECK NO:	3810			
	NAME:	POSEY, RON 4598 HAWAINA WAY KELSEYVILLE CA 95451-9756 US			
3	AMOUNT:	10.00	POSTMARKED:	08/22/2017	
	TYPE:	CHECK	RECEIVED:	08/23/2017	
	CHECK NO:	3811			
	NAME:	POSEY, RON 4598 HAWAINA WAY KELSEYVILLE CA 95451-9756 US			

4	AMOUNT:	10.00	POSTMARKED:	08/22/2017
	TYPE:	CHECK	RECEIVED:	08/23/2017
	CHECK NO:	3812		
	NAME:	POSEY, RON 4598 HAWAINA WAY KELSEYVILLE CA 95451-9756 US		

REMARKS

This receipt was generated by the automated BLM Collections and Billing System and is a paper representation of a portion of the official electronic record contained therein.

CALIFORNIA JURAT WITH AFFIANT STATEMENT

GOVERNMENT CODE § 8202

- See Attached Document (Notary to cross out lines 1-6 below)
- See Statement Below (Lines 1-6 to be completed only by document signer[s], not Notary)

~~_____

 _____~~

Signature of Document Signer No. 1 Signature of Document Signer No. 2 (if any)

RECEIVED
 CLERK OF SUPERIOR COURT
 PHOENIX, ARIZONA
 2017 AUG 23 AM 9:18

A notary public or other officer completing this certificate verifies only the identity of the individual who signed the document to which this certificate is attached, and not the truthfulness, accuracy, or validity of that document.

State of California
 County of Lake

Subscribed and sworn to (or affirmed) before me
 on this 18 day of August, 2017
 by Date Month Year

(1) Ronald Posey
 (and (2) _____),
 Name(s) of Signer(s)

proved to me on the basis of satisfactory evidence to be the person(s) who appeared before me.

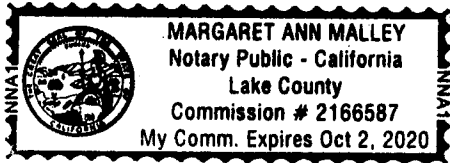

Place Notary Seal and/or Stamp Above

Signature Marge Malley
 Signature of Notary Public

OPTIONAL

Completing this information can deter alteration of the document or fraudulent reattachment of this form to an unintended document.

BLM Serial No. AMC427434, AMC427435, AMC427436, AMC427437

Description of Attached Document

Title or Type of Document: Affidavit of Annual Assessment Work

Document Date: August 18, 2017 Number of Pages: 3

Signer(s) Other Than Named Above: none

UNITED STATES
DEPARTMENT OF THE INTERIOR
BUREAU OF LAND MANAGEMENT

411
[Handwritten Signature]

AMC427434

MAINTENANCE FEE WAIVER CERTIFICATION

FORM APPROVED
OMB NO. 1004-0114
Expires: January 31, 2020

SEE INSTRUCTIONS ON PAGE 2

- This small miner waiver is filed for the assessment year beginning on September 1, 2017 and ending on September 1, 2018.
- The undersigned and all related parties owned ten or fewer mining claims, mill, or tunnel sites located and maintained on Federal lands in the United States of America on September 1, 2017.
- The undersigned have performed the assessment work required by law for each mining claim listed prior to filing this waiver and understand that by filing this form, the undersigned must file an affidavit of assessment work with the Bureau of Land Management (BLM) by the December 30th following the filing of this waiver.
- The undersigned understand that if the assessment work obligation has not yet come due under 30 U.S.C. 28 (for those claims in their first assessment year only), a notice of intent to hold reciting this condition must be recorded by the December 30th following the filing of this waiver.
- The undersigned understand that mill and tunnel sites may also be listed on this waiver and be waived from payment of the maintenance fee, and that a notice of intent to hold for these sites is required to be filed with the BLM by the December 30th following the filing of this waiver.
- The undersigned understand and acknowledge that pursuant to 43 U.S.C. 1212 and 18 U.S.C. 1001, the filing or recording of a false, fictitious, or fraudulent document with the BLM may result in a fine of up to \$250,000, a prison term not to exceed five years, or both.
- The mining claims, mill or tunnel sites for which this waiver from payment of the maintenance fees is requested are:

CLAIM OR SITE NAME	BLM RECORDATION SERIAL NUMBER
1. STOCKMYER NORTH	✓ AMC427434
2. STOCKMYER NORTH EXT.	AMC427435
3. STOCKMYER SOUTH	AMC427436
4. STOCKMYER SOUTH EXT.	AMC427437
5.	
6.	
7.	
8.	
9.	
10.	

RECEIVED
BLM AZ STATE OFFICE
2017 AUG 23 A 9 14
PHOENIX, ARIZONA

The owner(s) (claimants) of the above mining claims and sites are:

RONALD POSEY
(Owner's Name - Please Print)
4598 HAWAINA WAY
(Owner's Mailing Address)

Ronald Posey
(Owner's Signature)
KELSEYVILLE CA 95451
(City) (State) (Zip Code)

MARY POSEY
(Owner's Name - Please Print)
4598 HAWAINA WAY
(Owner's Mailing Address)

Mary Posey
(Owner's Signature)
KELSEYVILLE CA 95451
(City) (State) (Zip Code)

(Owner's Name - Please Print)
(Owner's Mailing Address)

(Owner's Signature)
(City) (State) (Zip Code)

(Owner's Name - Please Print)
(Owner's Mailing Address)

(Owner's Signature)
(City) (State) (Zip Code)

483
ENTERED
SEP 12 2017
BY: *[Signature]*

[Handwritten Signature]

UNITED STATES
DEPARTMENT OF THE INTERIOR
BUREAU OF LAND MANAGEMENT

AFFIDAVIT OF ANNUAL ASSESSMENT WORK

427434

WHEN RECORDED, MAIL DOCUMENT TO:

NAME: RONALD POSEY

ADDRESS: 4598 HAWAINA WAY

CITY, STATE, ZIP: KELSEYVILLE, CA 95451

FOR COUNTY RECORDER'S USE

No. of Claims ⁴ _____
x \$10/claim
Total due BLM \$ 40.00

TO ALL WHOM IT MAY CONCERN:

- The undersigned certifies that at least \$100 per claim was expended for development, labor and improvements, or equivalent value added, as the annual assessment work for the assessment year ending September 1, 2016 for the following contiguous unpatented mining claim(s), located in the County of YAVAPAI, in the State of ARIZONA.

BLM Serial No.	Name of Claim	Tp Rg Sec Mer				County Recordation Book and Page No.	Date
		Example: 13N 5E 14 MDM					
AMC427434	STOCKMYER NORTH	9N	5W	25	GSR	2014-0009161	2/26/2014
AMC427435	STOCKMYER NORTH EXT.	9N	5W	25	GSR	2014-0009162	2/26/2014
AMC427436	STOCKMYER SOUTH	9N	5W	25	GSR	2014-0009163	2/26/2014
AMC427437	STOCKMYER SOUTH EXT.	9N	5W	25	GSR	2014-0009164	2/26/2014

RECEIVED
BLM AZ STATE OFFICE
2016 SEP -1 PD 3 21
PHOENIX ARIZONA

MAINTENANCE FEE WAIVER ATTACHED

(Continued on page 2)

RECEIPT # 3650704

2. Type of labor and improvements (specify what was done and give the total value for that labor and improvement to show at least \$100 for each claim). If a geological, geochemical, or geophysical survey was performed, as per 30 U.S.C. 28-1, reference the title of the report of survey, give cost and date of the survey and report, and indicate it was filed with the County Recorder:

Description of Work Performed	Value of Work Performed	Date Work Was Performed
CLAIM IMPROVEMENTS	\$495.00	2015 - 2016

3. Name and mailing address of each person who performed the labor and improvements:

Name (please print)
RONALD POSEY

Current Mailing Address (please print)
4598 HAWAINA WAY KELSEYVILLE, CA 95451

4. Name and mailing address of each person who holds and claims the subject mining claim(s) for the valuable minerals contained therein. Be sure to indicate if there is a change of address:

Name (please print)
RONALD POSEY

Current Mailing Address (please print)
4598 HAWAINA WAY KELSEYVILLE, CA 95451

MARY POSEY

4598 HAWAINA WAY KELSEYVILLE, CA 95451

RECEIVED
 BLM AZ STATE OFFICE
 2016 SEP - 1 P 3:21
 PHOENIX, ARIZONA

5. The undersigned testifies that on the date of APRIL 25, 2016, all monuments required by law were erected upon the subject claim(s), and all notices required by law were posted on the subject claim(s) or copies thereof were in place, and at said date, each corner monument bore or contained

markings sufficient to appropriately designate the corner of the claim to which it pertains and the name of the claim(s).

I hereby certify under penalty of perjury under the laws of the State of ARIZONA that the foregoing statements are true and correct:

Ronald Posey
(Signature of person responsible for above statement)

Date: 8/25/16

Title 18 U.S.C. 1001 and 43 U.S.C. 1212 make it a crime for any person knowingly and willfully to make to any department or agency of the United States any false, fictitious or fraudulent statements or representations as to any matter within its jurisdiction.

Notary Block

SUBSCRIBED AND SWORN TO before me, this 25th day of August 20 16

By: Pati Giumelli - Pati Giumelli
(Signature of Affiant)

Title: Notary Public

My Commission Expires: July 8, 2018



INSTRUCTIONS

1. This is an optional form that may be used to satisfy the requirements for the Bureau of Land Management (BLM) under the provisions of 43 U.S.C. §1744 and 30 U.S.C. §28-28d and the regulations thereunder (43 CFR part 3835). Since local and State laws may vary, you should contact your local and State agencies where the claims are located to ensure all applicable laws and requirements are satisfied.
2. The claimant(s) must fill in the date in paragraph 1 for the applicable assessment year and the county and state where the claims are located.
3. All claim names, BLM serial numbers, legal descriptions, and original county recording information must be listed for the claims pertaining to this assessment notice.
4. The claimant(s) must complete paragraph 2 listing all labor or improvements which was performed on or did benefit the subject mining claims. The value and date of the labor or improvements must also be listed. The total amount of labor or improvements can be listed, but the total expenditure must equal at least \$100 for each claim.
5. The names and current mailing addresses of the person(s) performing the labor shall be listed in paragraph 3.
6. The name and current mailing address of each owner (claimant) of the claims shall be listed in paragraph 4. The mailing address shall be the owner's address and not the address of an agent or anyone representing the claimant. Be sure to note if there has been a change of address.
7. Paragraph 5 shall be completed to show the date it was verified that all monuments required by law were properly erected, all notices were posted, and that corners were appropriately designated for all claims listed.
8. An exact legible reproduction or duplicate (other than microfilm or other electronic media) of this affidavit or another type of affidavit of assessment work that you file or will file in the county where each claim is located, must be filed with the BLM on or before December 30 of the calendar year in which the assessment year ends. For mill or tunnel sites, a separate notice of intent to hold must be filed with the BLM on or before December 30. Requirements for filing a notice of intent to hold can be found at 43 CFR 3835.33.
9. A processing fee of \$10 for each claim listed must be remitted to the BLM along with this or any other affidavit of assessment work.

PHOTOGRAPHY
2016-11-03 3:21
BLM
ASSESSMENT OFFICE
LAKE COUNTY



Mr. Ronald Posey
 4598 Hawaina Way
 Kelseyville, CA 95451



RECEIVED
 BLM AZ STATE OFFICE

2016 SEP -1 P 3:21

PHOENIX, ARIZONA

BUREAU OF LAND MANAGEMENT
 ARIZONA STATE OFFICE
 ONE NORTH CENTRAL AVE, SUITE 800
 PHOENIX, AZ 85004-4427

850044427 0041



United States Department of the Interior
Bureau of Land Management
 DIV OF LANDS, MINRLS & ENERGY
 ONE N CENTRAL AVE
 PHOENIX, AZ 85004 -4427
 Phone: 602-417-9200

Receipt

No: 3650704

Transaction #: 3754724	
Date of Transaction: 09/02/2016	
CUSTOMER:	
RONALD POSEY 4598 HAWAINA WAY KELSEYVILLE, CA 95451-9756 US	

LINE #	QTY	DESCRIPTION	REMARKS	UNIT PRICE	TOTAL
1	1.00	LOCATABLE MINERALS / MINING CLAIMS-NOT NEW-UNADJUD, ONE AUTH NO. ONLY / MINING CLAIM MONEY RECEIVED CASES: AMC427434/\$40.00	WAIVER 2017 - 4 / POL 2016 - 4	- n/a -	40.00
TOTAL:					\$40.00

PAYMENT INFORMATION			
1	AMOUNT:	40.00	POSTMARKED: 08/29/2016
	TYPE:	CHECK	RECEIVED: 09/01/2016
	CHECK NO:	3542	
	NAME:	POSEY, RON 4598 HAWAINA WAY KELSEYVILLE CA 95451-9756 US	

REMARKS

This receipt was generated by the automated BLM Collections and Billing System and is a paper representation of a portion of the official electronic record contained therein.

ENTERED
 SEP - 6 2016
 BY: 

MAINTENANCE FEE WAIVER CERTIFICATION

Handwritten signature

FORM APPROVED
OMB NO. 1004-0114
Expires: October 31, 2016

SEE INSTRUCTIONS ON PAGE 2

427434

- This small miner waiver is filed for the assessment year beginning on September 1, 2016 and ending on September 1, 2017.
- The undersigned and all related parties owned ten or fewer mining claims, mill, or tunnel sites located and maintained on Federal lands in the United States of America on September 1, 2016.
- The undersigned have performed the assessment work required by law for each mining claim listed prior to filing this waiver and understand that by filing this form, the undersigned must file an affidavit of assessment work with the Bureau of Land Management (BLM) by the December 30th following the filing of this waiver.
- The undersigned understand that if the assessment work obligation has not yet come due under 30 U.S.C. 28 (for those claims in their first assessment year only), a notice of intent to hold reciting this condition must be recorded by the December 30th following the filing of this waiver.
- The undersigned understand that mill and tunnel sites may also be listed on this waiver and be waived from payment of the maintenance fee, and that a notice of intent to hold for these sites is required to be filed with the BLM by the December 30th following the filing of this waiver.
- The undersigned understand and acknowledge that pursuant to 43 U.S.C. 1212 and 18 U.S.C. 1001, the filing or recording of a false, fictitious, or fraudulent document with the BLM may result in a fine of up to \$250,000, a prison term not to exceed five years, or both.
- The mining claims, mill or tunnel sites for which this waiver from payment of the maintenance fees is requested are:

CLAIM OR SITE NAME	BLM RECORDATION SERIAL NUMBER
1. STOCKMYER NORTH	AMC427434 ✓
2. STOCKMYER NORTH EXT.	AMC427435
3. STOCKMYER SOUTH	AMC427436
4. STOCKMYER SOUTH EXT.	AMC427437
5.	
6.	
7.	
8.	
9.	
10.	

RECEIVED
BLM AZ STATE OFFICE
2016 SEP - 1 P 3: 21
PHOENIX, ARIZONA

The owner(s) (claimants) of the above mining claims and sites are:

RONALD POSEY

 (Owner's Name - Please Print)
 4598 HAWAINA WAY

 (Owner's Mailing Address)

Ronald Posey

 (Owner's Signature)
 KELSEYVILLE CA 95451

 (City) (State) (Zip Code)

MARY POSEY

 (Owner's Name - Please Print)
 4598 HAWAINA WAY

 (Owner's Mailing Address)

Mary Posey

 (Owner's Signature)
 KELSEYVILLE CA 95451

 (City) (State) (Zip Code)

 (Owner's Name - Please Print)

 (Owner's Mailing Address)

 (Owner's Signature)

 (City) (State) (Zip Code)

 (Owner's Name - Please Print)

 (Owner's Mailing Address)

 (Owner's Signature)

 (City) (State) (Zip Code)

(Continued on page 2)

INTEREST
 483
 SEP 08 2016
 BY: *[Signature]*

Handwritten initials

UNITED STATES
DEPARTMENT OF THE INTERIOR
BUREAU OF LAND MANAGEMENT

601

A.A.

427434

MAINTENANCE FEE WAIVER CERTIFICATION

FORM APPROVED
OMB NO. 1004-0114
Expires: October 31, 2016

SEE INSTRUCTIONS ON PAGE 2

1. This small miner waiver is filed for the assessment year beginning on September 1, 2015 and ending on September 1, 2016.
2. The undersigned and all related parties owned ten or fewer mining claims, mill, or tunnel sites located and maintained on Federal lands in the United States of America on September 1, 2015.
3. The undersigned have performed the assessment work required by law for each mining claim listed prior to filing this waiver and understand that by filing this form, the undersigned must file an affidavit of assessment work with the Bureau of Land Management (BLM) by the December 30th following the filing of this waiver.
4. The undersigned understand that if the assessment work obligation has not yet come due under 30 U.S.C. 28 (for those claims in their first assessment year only), a notice of intent to hold reciting this condition must be recorded by the December 30th following the filing of this waiver.
5. The undersigned understand that mill and tunnel sites may also be listed on this waiver and be waived from payment of the maintenance fee, and that a notice of intent to hold for these sites is required to be filed with the BLM by the December 30th following the filing of this waiver.
6. The undersigned understand and acknowledge that pursuant to 43 U.S.C. 1212 and 18 U.S.C. 1001, the filing or recording of a false, fictitious, or fraudulent document with the BLM may result in a fine of up to \$250,000, a prison term not to exceed five years, or both.
7. The mining claims, mill or tunnel sites for which this waiver from payment of the maintenance fees is requested are:

CLAIM OR SITE NAME	BLM RECORDATION SERIAL NUMBER
1. STOCKMYER NORTH	AMC 427434 ✓
2. STOCKMYER NORTH EXT	AMC 427435
3. STOCKMYER SOUTH	AMC 427436
4. STOCKMYER SOUTH EXT	AMC 427437
5.	
6.	
7.	
8.	
9.	
10.	

The owner(s) (claimants) of the above mining claims and sites are:

RONALD POSEY
(Owner's Name - Please Print)
4598 HAWAIIA WAY
(Owner's Mailing Address)

Ronald Posey
(Owner's Signature)
KELSEYVILLE CA 95451
(City) (State) (Zip Code)

MARY POSEY
(Owner's Name - Please Print)
4598 HAWAIIA WAY
(Owner's Mailing Address)

Mary Posey
(Owner's Signature)
KELSEYVILLE CA 95451
(City) (State) (Zip Code)

(Owner's Name - Please Print)

(Owner's Mailing Address)

(Owner's Signature)

(City) (State) (Zip Code)

(Owner's Name - Please Print)

(Owner's Mailing Address)

(Owner's Signature)

(City) (State) (Zip Code)

INTEREST
SEP 09 2015
BY: [Signature]

RECEIVED
BLM AZ STATE OFFICE
PHOENIX, ARIZONA
2015 AUG 24 P 2:48

NW
9/9/2015
[Signature]

(Owner's Name - Please Print)	(Owner's Signature)		
(Owner's Mailing Address)	(City)	(State)	(Zip Code)
(Owner's Name - Please Print)	(Owner's Signature)		
(Owner's Mailing Address)	(City)	(State)	(Zip Code)
(Owner's Name - Please Print)	(Owner's Signature)		
(Owner's Mailing Address)	(City)	(State)	(Zip Code)
(Owner's Name - Please Print)	(Owner's Signature)		
(Owner's Mailing Address)	(City)	(State)	(Zip Code)

18 U.S.C. 1001 and 43 U.S.C. 1212 make it a crime for any person knowingly and willfully to make to any department or agency of the United States any false, fictitious or fraudulent statements or representations as to any matter within its jurisdiction.

INSTRUCTIONS

1. This certification is made under the provisions of 43 U.S.C. § 1744 and 30 U.S.C. §28-28k and the regulations thereunder (43 CFR Part 3830).
2. The claimant(s) must fill in the dates in paragraph 1 for the beginning and ending of the assessment year for which this waiver is sought.
3. The claimant(s) must fill in the date in paragraph 2 for the beginning of the assessment year for which this waiver is sought.
4. All claim and site names and BLM serial numbers must be listed for the mining claims, mill sites, and tunnel sites for which the waiver is sought.
5. All owners of the mining claims, mill sites, and tunnel sites and their addresses must be given.
6. This waiver form must be signed by all the claimants or their designated agent, in original form. If an agent is designated, a notarized designation of agent, signed by all of the claimants with proper address given, must be submitted with this waiver.
7. This form must be filed no later than September 1st for the upcoming assessment year in the BLM State Office where the mining claims or sites are recorded, or the waiver cannot be granted by the BLM. (Example: To obtain a waiver for the assessment year 2012, which begins on September 1, 2011, you must qualify for and file for a waiver no later than September 1, 2011, in the proper BLM State Office.)
8. For all mining claims which require assessment work, you must record an affidavit of labor on or before the December 30th immediately following the filing of this waiver. For all other mining claims or sites waived, you must record a notice of intent to hold on or before the December 30th immediately following the filing of this waiver.
9. Mill and tunnel sites may also be listed on this waiver and be waived from payment of the maintenance fee. A notice of intent to hold for these sites is required to be filed by the December 30th following the filing of this waiver.

RECEIVED
 BLM STATE OFFICE
 PHOENIX, ARIZONA
 2015 AUG 24 P 2:48

FOR OFFICIAL USE ONLY

AFFIDAVIT OF ANNUAL ASSESSMENT WORK

~~427434~~

427434

WHEN RECORDED, MAIL DOCUMENT TO:

NAME: RONALD POSEY

ADDRESS: 4598 HAWAIIA WAY

CITY, STATE, ZIP: KELSEYVILLE, CA 95451

FOR COUNTY RECORDER'S USE

No. of Claims 4

x \$10/claim

Total due BLM \$ 40.00

TO ALL WHOM IT MAY CONCERN:

1. The undersigned certifies that at least \$100 per claim was expended for development, labor and improvements, or equivalent value added, as the annual assessment work for the assessment year ending September 1, 2015 for the following contiguous unpatented mining claim(s), located in the County of YAVAPAI, in the State of ARIZONA.

BLM Serial No.	Name of Claim	Tp	Rg	Sec	Mer	County Recordation Book and Page No.	Date
		Example: 13N 5E 14 MDM					
AMC 427434	Stockmyer North	9N	5W	25	GSR	2014-0009161	2/26/14
AMC 427435	Stockmyer North Ext	9N	5W	25	GSR	2014-0009162	2/26/14
AMC 427436	Stockmyer South	9N	5W	25	GSR	2014-0009163	2/26/14
AMC 427437	Stockmyer South Ext	9N	5W	25	GSR	2014-0009164	2/26/14

RECEIVED
 BLM RECORDER'S OFFICE
 2015 AUG 24 P 2:47
 PHOENIX, ARIZONA

INTERIOR
 AUG 23 2015
 BK - RAN

(Continued on page 2)

2 SIDED DOC

RECEIPT # 3376473

2. Type of labor and improvements (specify what was done and give the total value for that labor and improvement to show at least \$100 for each claim). If a geological, geochemical, or geophysical survey was performed, as per 30 U.S.C. 28-1, reference the title of the report of survey, give cost and date of the survey and report, and indicate it was filed with the County Recorder:

Description of Work Performed	Value of Work Performed	Date Work Was Performed
CLAIM IMPROVEMENTS	\$556.00	2014-2015

3. Name and mailing address of each person who performed the labor and improvements:

<p>Name (please print)</p> <p><u>RONALD POSEY</u></p> <p>_____</p> <p>_____</p> <p>_____</p>	<p>Current Mailing Address (please print)</p> <p><u>4598 HAWAINA WAY KELSEYVILLE, CA 95451</u></p> <p>_____</p> <p>_____</p> <p>_____</p>
--	---

4. Name and mailing address of each person who holds and claims the subject mining claim(s) for the valuable minerals contained therein. Be sure to indicate if there is a change of address:

<p>Name (please print)</p> <p><u>RONALD POSEY</u></p> <p><u>MARY POSEY</u></p> <p>_____</p> <p>_____</p> <p>_____</p> <p>_____</p>	<p>Current Mailing Address (please print)</p> <p><u>4598 HAWAINA WAY KELSEYVILLE, CA 95451</u></p> <p><u>4598 HAWAINA WAY KELSEYVILLE, CA 95451</u></p> <p>_____</p> <p>_____</p> <p>_____</p>
--	--

BLM RECEIVED OFFICE
 2015 AUG 24 P 2:48
 PHOENIX, ARIZONA

5. The undersigned testifies that on the date of AUGUST 7, 2015, all monuments required by law were erected upon the subject claim(s), and all notices required by law were posted on the subject claim(s) or copies thereof were in place, and at said date, each corner monument bore or contained

markings sufficient to appropriately designate the corner of the claim to which it pertains and the name of the claim(s).

I hereby certify under penalty of perjury under the laws of the State of CA that the foregoing statements are true and correct:

Ronald Posey
(Signature of person responsible for above statement)

Date: August 21, 2015

Title 18 U.S.C. 1001 and 43 U.S.C. 1212 make it a crime for any person knowingly and willfully to make to any department or agency of the United States any false, fictitious or fraudulent statements or representations as to any matter within its jurisdiction.

Notary Block

SUBSCRIBED AND SWORN TO before me, this 21st day of August 2015

By: Sophia Koot
(Signature of Affiant)

Title: Notary Public

My Commission Expires: JAN. 27th, 2017

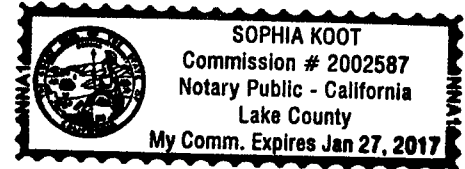

INSTRUCTIONS

See Attached

1. This is an optional form that may be used to satisfy the requirements for the Bureau of Land Management (BLM) under the provisions of 43 U.S.C. §1744 and 30 U.S.C. §28-28d and the regulations thereunder (43 CFR part 3835). Since local and State laws may vary, you should contact your local and State agencies where the claims are located to ensure all applicable laws and requirements are satisfied.
2. The claimant(s) must fill in the date in paragraph 1 for the applicable assessment year and the county and state where the claims are located.
3. All claim names, BLM serial numbers, legal descriptions, and original county recording information must be listed for the claims pertaining to this assessment notice.
4. The claimant(s) must complete paragraph 2 listing all labor or improvements which was performed on or did benefit the subject mining claims. The value and date of the labor or improvements must also be listed. The total amount of labor or improvements can be listed, but the total expenditure must equal at least \$100 for each claim.
5. The names and current mailing addresses of the person(s) performing the labor shall be listed in paragraph 3.
6. The name and current mailing address of each owner (claimant) of the claims shall be listed in paragraph 4. The mailing address shall be the owner's address and not the address of an agent or anyone representing the claimant. Be sure to note if there has been a change of address.
7. Paragraph 5 shall be completed to show the date it was verified that all monuments required by law were properly erected, all notices were posted, and that corners were appropriately designated for all claims listed.
8. An exact legible reproduction or duplicate (other than microfilm or other electronic media) of this affidavit or another type of affidavit of assessment work that you file or will file in the county where each claim is located, must be filed with the BLM on or before December 30 of the calendar year in which the assessment year ends. For mill or tunnel sites, a separate notice of intent to hold must be filed with the BLM on or before December 30. Requirements for filing a notice of intent to hold can be found at 43 CFR 3835.33.
9. A processing fee of \$10 for each claim listed must be remitted to the BLM along with this or any other affidavit of assessment work.

RECEIVED
2015 AUG 21 2:47
PERRY ARIZONA

NOTICES

THE PRIVACY ACT and 43 CFR 2.48(d) require that you be furnished with the following information in connection with the information requested by this form.

AUTHORITY: 30 U.S.C. §28-28d and 43 CFR part 3835 permit collection of the information requested by this form.

PRINCIPAL PURPOSE: The BLM will use the information you provide to document compliance with 43 U.S.C. 1744 and that assessment work has been completed in accordance with 30 U.S.C. § 28-28d and 43 CFR part 3835 in lieu of paying the maintenance fee for the mining claims listed on this form.

ROUTINE USES: The BLM will only disclose this information in accordance with the provisions at 43 CFR 2.56(b) and (c).

EFFECT OF NOT PROVIDING INFORMATION: Disclosure of the requested information is required by 30 U.S.C. § 28-28d and 43 CFR part 3835 for claimants qualified to perform assessment work in lieu of paying the maintenance fee. Failure to submit all the requested information or to complete this form will delay the BLM's processing of the form and may preclude the BLM's acceptance of the assessment work information, which may result in forfeiture of the mining claim(s) by the claimant.

THE PAPERWORK REDUCTION ACT requires us to inform you that:

Use of this form is optional. You must perform assessment if a waiver to pay the maintenance fee has been requested. This form is provided to help you attest that annual assessment work has been completed in lieu of paying the maintenance fee for your claim(s). Submission of the requested information is necessary to obtain or retain a benefit.

You do not have to respond to this or any other Federal agency-sponsored information collection unless it displays a valid OMB control number.

BURDEN HOURS STATEMENT: The estimated public reporting burden for this form is 30 minutes per response, including the time for reviewing instructions, gathering and maintaining data, and completing and reviewing the form. You may submit comments regarding the burden estimate or any other aspect of this form to: U.S. Department of the Interior, Bureau of Land Management (1004-0114), Bureau Information Collection Clearance Officer (WO-630), 1849 C Street, N.W., Room 2134LM, Washington, D.C. 20240.

RECEIVED
BLM AZ SERVICE OFFICE
2015 AUG 24 P 2:48
PHOENIX, ARIZONA

CALIFORNIA JURAT WITH AFFIANT STATEMENT

GOVERNMENT CODE § 8202

- See Attached Document (Notary to cross out lines 1-6 below)
- See Statement Below (Lines 1-6 to be completed only by document signer[s], *not* Notary)

RECEIVED
BLM AGENCY OFFICE
2015 AUG 24 P 2:47
PHOENIX, ARIZONA

~~_____

_____~~

Ronald Posey
Signature of Document Signer No. 1

Signature of Document Signer No. 2 (if any)

A notary public or other officer completing this certificate verifies only the identity of the individual who signed the document to which this certificate is attached, and not the truthfulness, accuracy, or validity of that document.

State of California
County of Lake

Subscribed and sworn to (or affirmed) before me
on this 21st day of August, 2015
by Ronald Posey
(1) _____
(and (2) _____),
Name(s) of Signer(s)



proved to me on the basis of satisfactory evidence
to be the person(s) who appeared before me.
Signature Sophia Koot
Signature of Notary Public

Seal
Place Notary Seal Above

OPTIONAL

Though this section is optional, completing this information can deter alteration of the document or fraudulent reattachment of this form to an unintended document.

Description of Attached Document
Title or Type of Document: Annual Assessment Workbook Document Date: 0
Number of Pages: 21 Signer(s) Other Than Named Above: _____

PRESS FIRMLY TO SEAL

PRESS FIRMLY TO SEAL



1022



85004

U.S. POSTAGE
PAID
LOWER LAKE, CA
95457
AUG 21, 15
AMOUNT

\$5.75
R2305H128161-03

PRIORITY® ★ MAIL ★

DATE OF DELIVERY SPECIFIED *

USPS TRACKING™ INCLUDED *

INSURANCE INCLUDED *

PICKUP AVAILABLE

* Domestic only

Expected Delivery Day: 08/24/2015

USPS TRACKING NUMBER



9505 5101 2186 5233 0003 90

FROM:

PRIORITY® ★ MAIL ★



VISIT US AT USPS.COM
ORDER FREE SUPPLIES ONLINE

FROM: *Ronald Rosey*
4598 HOLWAIN WAY
Kelseyville, CA 95451

TO: *BLM ARIZONA State Office*
ONE North Central Ave
Suite 800
Phoenix, AZ 85004-4427

Label 228, July 2013

FOR DOMESTIC AND INTERNATIONAL USE

WHEN USED INTERNATIONALLY,
A CUSTOMS DECLARATION
LABEL MAY BE REQUIRED.

RECEIVED
BLM AZ STATE OFFICE

2015 AUG 24 P 2

PHOENIX, ARIZONA



PS00001000014

EP14F July 2013
OD: 12.5 x 9.5

VISIT US AT USPS.COM
ORDER FREE SUPPLIES ONLINE



This packaging is the property of the U.S. Postal Service® and is provided solely for use in sending Priority Mail® shipments. Misuse may be a violation of federal law. This packaging is not for resale. EP14F © U.S. Postal Service, July 2013; All rights reserved.

This envelope is made from post-consumer waste. Please recycle - again.

United States Department of the Interior
Bureau of Land Management
 LANDS/RECREATION & PLANNING
 ONE N CENTRAL AVE
 PHOENIX, AZ 85004 -2203
 Phone: 602-417-9200

Receipt

No: 3376473

Transaction #: 3474707	
Date of Transaction: 08/25/2015	
CUSTOMER:	
RONALD POSEY 4598 HAWAINA WAY KELSEYVILLE, CA 95451-9756 US	

LINE #	QTY	DESCRIPTION	REMARKS	UNIT PRICE	TOTAL
1	1.00	LOCATABLE MINERALS / MINING CLAIMS-NOT NEW-UNADJUD, ONE AUTH NO. ONLY / MINING CLAIM MONEY RECEIVED CASES: AMC427434/\$40.00	WAIVER - 4 2016 / POL - 4 2015	- n/a -	40.00
TOTAL:					\$40.00

PAYMENT INFORMATION				
NOTE: Items will appear on credit card statement as "Bureau of Land Mgmt CO".				
1	AMOUNT:	40.00	POSTMARKED:	N/A
	TYPE:	CREDIT CARD	RECEIVED:	08/24/2015
	NAME:	POSEY, RONALD 4598 HAWAINA WAY KELSEYVILLE CA 95451-9756 US		
	CARD NO:	XXXXXXXXXXXX3010	AUTH CODE:	02518B
	NAME ON CARD:	RON POSEY		
	EXPIRES:	09/2019		
	SIGNATURE:			

REMARKS

This receipt was generated by the automated BLM Collections and Billing System and is a paper representation of a portion of the official electronic record contained therein.

AUG 28 2015
 BY: *R. Posey*

UNITED STATES 1629
DEPARTMENT OF THE INTERIOR
BUREAU OF LAND MANAGEMENT

MAINTENANCE FEE WAIVER CERTIFICATION

AMC 427434

FORM APPROVED
OMB NO. 1004-0114
Expires: October 31, 2016

SEE INSTRUCTIONS ON PAGE 2 4/30

1. This small miner waiver is filed for the assessment year beginning on September 1, 2014 and ending on September 1, 2015.
2. The undersigned and all related parties owned ten or fewer mining claims, mill, or tunnel sites located and maintained on Federal lands in the United States of America on September 1, 2014.
3. The undersigned have performed the assessment work required by law for each mining claim listed prior to filing this waiver and understand that by filing this form, the undersigned must file an affidavit of assessment work with the Bureau of Land Management (BLM) by the December 30th following the filing of this waiver.
4. The undersigned understand that if the assessment work obligation has not yet come due under 30 U.S.C. 28 (for those claims in their first assessment year only), a notice of intent to hold reciting this condition must be recorded by the December 30th following the filing of this waiver.
5. The undersigned understand that mill and tunnel sites may also be listed on this waiver and be waived from payment of the maintenance fee, and that a notice of intent to hold for these sites is required to be filed with the BLM by the December 30th following the filing of this waiver.
6. The undersigned understand and acknowledge that pursuant to 43 U.S.C. 1212 and 18 U.S.C. 1001, the filing or recording of a false, fictitious, or fraudulent document with the BLM may result in a fine of up to \$250,000, a prison term not to exceed five years, or both.
7. The mining claims, mill or tunnel sites for which this waiver from payment of the maintenance fees is requested are:

	CLAIM OR SITE NAME		BLM RECORDATION SERIAL NUMBER
1.	Stockmyer North	✓	AMC 427434 L
2.	Stockmyer South		AMC 427436
3.	Stockmyer North Ext.		AMC 427435
4.	Stockmyer South Ext		AMC 427437
5.			
6.			
7.			
8.			
9.			
10.			

The owner(s) (claimants) of the above mining claims and sites are:

Ronald Posey ✓
(Owner's Name - Please Print)
4598 HAWAIIA Way
(Owner's Mailing Address)

Ronald Posey
(Owner's Signature)
Kelseyville CA 95451
(City) (State) (Zip Code)

Mary Posey ✓
(Owner's Name - Please Print)
4598 HAWAIIA Way
(Owner's Mailing Address)

Mary Posey
(Owner's Signature)
Kelseyville CA 95451
(City) (State) (Zip Code)

(Owner's Name - Please Print)

(Owner's Mailing Address)

(Owner's Signature)

(City) (State) (Zip Code)

ENTERED
AC-433
SEP 15 2014
BY: PB

RECEIVED
PHOENIX, ARIZONA
2014 AUG 28
11 AM AZ STATE OFFICE
A-10-42

(Owner's Name - Please Print)
NEW CHECKED SEP 23 2014 PB
(Owner's Mailing Address)

(Owner's Signature)

(City) (State) (Zip Code)

NOTICE OF INTENTION TO HOLD MINING CLAIMS/SITES

When Recorded Return Document to:

Ronald Posey
4598 HAWAIIA WAY
Kelseyville, CA 95451

RECEIVED
 M AZ STATE OFFICE
 AUG 28 A 10:42
 PHOENIX, ARIZONA
 BLM
 Date
 Stamp

Check here if this is a change of address.
 Telephone: _____
 E-mail Address _____

I (We) intend to hold the claims(s) and/or site(s) listed below for the calendar year 2014 and I (We) have filed or will file a Notice of Intent to Hold in the county where the claim (s) is located.

Reason for filing a Notice of Intent to Hold instead of an assessment work filing (check one):

- Maintenance fee was paid to maintain claim(s) during this assessment year.
- Mill or tunnel sites.
- Claim(s) was located during the current assessment year.
- BLM has deferred assessment work (attach copy of decision granting deferment, or pending petition for deferment including date petition was filed.)

Line No.	AMC NUMBER	CLAIM/SITE NAME	COUNTY RECORDER DATA (If available)	TWP	RNG	SEC
1	427434	Stockmyer North	2014-	9N	5W	25
2	427436	Stockmyer South	2014-	9N	5W	25
3	427435	Stockmyer North Ext	2014-	9N	5W	25
4	427437	Stockmyer South Ext	2014-	9N	5W	25
5						
6						
7						
8						
9						
10						

Two Sided Doc

Form: MCF110
 Revised Jan. 2006
 Page 1 of 2
 SEP 02 2014
 BY: Rdn

NOTICE OF INTENTION TO HOLD MINING CLAIMS/SITES
page 2

RECEIVED
M AZ STATE OFFICE
2014 AUG 28 A 10:42
PHOENIX, ARIZONA
BLM
Date
Stamp

1. State of Arizona, County of YAVAPAI

2. I (Name) Ronald Posey

3. Reside at (Address) 4598 HAWAIIA WAY

City Kelseyville County _____ State CA Zip 95451 being duly sworn, depose and say that I am a citizen of the United States, more than eighteen years of age, that all of the facts set forth in this notice, subject to the provisions and penalties of 18 U.S.C. 1001 pertaining to the filing of false, fictitious, or fraudulent statements with the United States, are true and correct according to the best of my knowledge, information and belief.

4. Owner's name and address (If not shown in Items 1-3 above). _____

5. Dated: 8/25/14 Signature: Ronald Posey

Bureau of Land Management
Arizona State Office
www.az.blm.gov

No. of Claims: 4 x \$10 = 40
Check No: CASH Init. SC
Receipt No.: 3115419
For BLM Use Only

Form: MCF110
Revised Jan. 2006
Page 2 of 2



United States Department of the Interior
Bureau of Land Management
 LANDS/RECREATION & PLANNING
 ONE N CENTRAL AVE
 PHOENIX, AZ 85004 -2203
 Phone: 602-417-9200

Receipt

No: 3115419

Transaction #: 3207163	
Date of Transaction: 08/28/2014	
CUSTOMER:	
RONALD POSEY 4598 HAWAINA WAY KELSEYVILLE, CA 95451-9756 US	

LINE #	QTY	DESCRIPTION	REMARKS	UNIT PRICE	TOTAL
1	1.00	LOCATABLE MINERALS / MINING CLAIMS- NOT NEW-UNADJUD, ONE AUTH NO. ONLY / MINING CLAIM MONEY RECEIVED CASES: AMC427434/\$40.00	WAIVER 2015 POE 2014 (4) No 1	- n/a -	40.00
TOTAL:					\$40.00

PAYMENT INFORMATION			
1	AMOUNT:	40.00	POSTMARKED: N/A
	TYPE:	CASH	RECEIVED: 08/28/2014
	NAME:	POSEY, RONALD 4598 HAWAINA WAY KELSEYVILLE CA 95451-9756 US	

REMARKS

This receipt was generated by the automated BLM Collections and Billing System and is a paper representation of a portion of the official electronic record contained therein.

NOTICE!!

These documents have been scanned!

Do not place un-scanned documents beneath this notice!

Do not remove this notice from this file!

GPO Jacket No. 560-102
Print Order 61540
Rise Business Services, LLC
Job=AZ15 6/24/2019



Box Number= AZ15129



Claim Begin-End: AMC427434-AMC427437

5 Miscellaneous



AZ15129-11

AMC364820-AMC427442

**NO
DOCUMENTS
FOUND**

NO DOCUMENTS FOUND
NO DOCUMENTS FOUND

NOTICE!!

These documents have been scanned!

Do not place un-scanned documents beneath this notice!

Do not remove this notice from this file!

GPO Jacket No. 560-102
Print Order 61540
Rise Business Services, LLC
Job=AZ15 6/24/2019



Box Number= AZ15129



Claim Begin-End: AMC427434-AMC427437

6 Location Notices-Amendments and Supporting Documents



AZ15129-11

AMC364820-AMC427442

Corrected AMC 427435

Re: AMC 427435 (Stockmyer North Ext)

The purpose of this Document is to clarify the Location Notice of AMC 427435 filed with the Yavapai County Recorders Office instrument number 2014-0009182.

Reference (exhibit AMC 427435)

- 1) Re: 43 CFR 3832.12 (c) (1) (iii), The West Boundary line of AMC 427435 follows the existing East Boundary line of Dream Catcher (AMC 418635), therefore being non-aliquot, is described in meets and bounds.
- 2) Re: Snowflake Fraction Placer, 37 Pub. Lands Dec. 250 (1908) 1 or 2 Locators, The boundaries of this claim remain within the boundaries of a 40 acre square parcel.

RECEIVED
BLM AZ STATE OFFICE
2014 AUG 19 P 1:54
PHOENIX, ARIZONA

AMC 427437

Filed as a clarification
of the claim description.
Therefore, no Notice to Amend
was sent. RE 10.20.14
Reqs met.

MAIL TO

LOCATION NOTICE FOR PLACER MINING CLAIM

NOTICE IS HEREBY GIVEN

that the Stockmyer North Ext

placer mining claim has been located by

Ronald Posey

whose current mailing address is

4598 HAWAIIA WAY
KELSEYVILLE, CA
95451

The general course of this claim is North to South and it is situated in Yavapai County, Arizona.

BLM
Date
Stamp

RECEIVED
BLM AZ STATE OFFICE
2014 FEB 28 A 11: 57
PHOENIX, ARIZONA

This Claim is irregular in shape

Beginning at the SE corner monument on which this location notice is posted course due West 1020 ft to the SW corner, then course 1435 at 21 degrees NE to the NW corner then, course 440 feet due East to the NE corner, then course 1320 ft due South back to the beginning at the SE corner of this claim.

This claim is marked by 4 monuments, one at each corner of the claim

The location monument on which this notice is posted is situated within Section 25, Township 9N, Range 5W Gila and Salt River Meridian, Weaver Mining District, Yavapai County, Arizona.

This claim encompasses portions of the following quarter section(s), NW of section 25, T9N, R5W, Gila and Salt River Meridian, Weaver Mining District, Yavapai County, Arizona.

The locality of this claim with reference to some natural object or permanent monument and additional information (if any) concerning its locality is as follows:

1. The SE corner of the claim is 1320 feet due South then 2640 due West of the NE corner survey monument of Section 25, T9N, R5W Gila and Salt River Meridian, Weaver Mining District, Yavapai County, Arizona.

DATED AND POSTED on the ground this 26th day of, February 2014.

LOCATOR(s) RONALD POSEY Ronald Posey

Agent Only () MARY POSEY Mary Posey

AM0427435

33.61

Location Notice for Placer Mining Claim

page 2

MINING CLAIM MAP

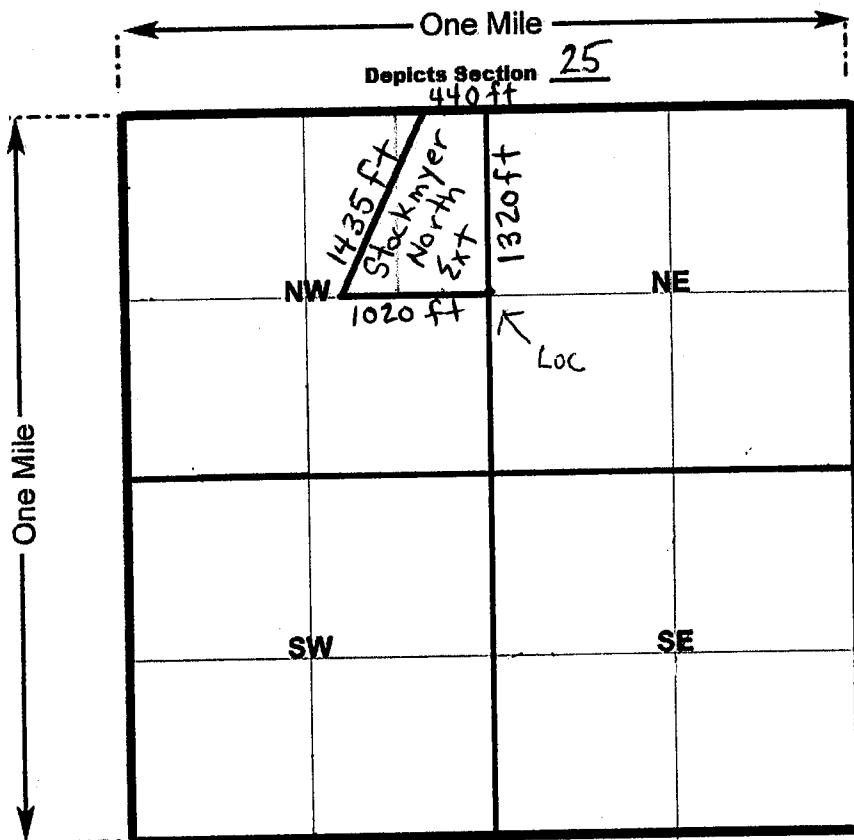

PHOENIX, ARIZONA

2014 FEB 28 A 11: 57

RECEIVED
CLM AZ STATE OFFICE

Section 25 Township 9N Range 5W Gila and Salt River Meridian
One inch = 1320 feet

1. The above map depicts the Stockmyer North Ext placer mining claim located in Section 25 Township 9N Range 5W Gila and Salt River Meridian, Weaver Mining District, Yavapai County, Arizona.

2. The Type of corner and location monuments used are 2 inch white PVC posts more than 4 foot tall.

3. The bearings and distances in degrees and feet feet between claim corners are as depicted on the above map.

AMC421435

Exhibit AMC 427435

Placer Mining Claim

AMC 427435

Section 25 NW 1/4

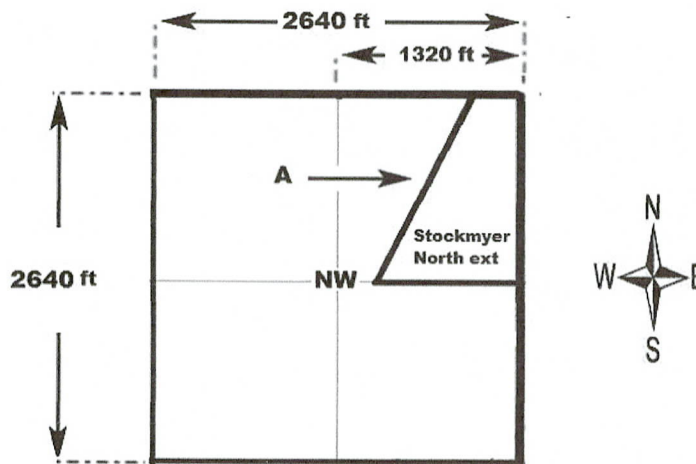

One inch = 1320 feet

1. The above map depicts the Stockmyer North Ext (AMC 427435) placer mining claim located in Section 25 Township 9N Range 5W Gila and Salt River Meridian, Weaver Mining District, Yavapai County, Arizona.

CLAIM IS BORDERED ON DEPICTED SIDE(S) BY THE FOLLOWING CLAIM(S)

A) AMC 418634

RECEIVED
M AZ STATE OFFICE
2014 AUG 19 P 1:54
PHOENIX, ARIZONA

AMENDMENT FOR LOCATION NOTICE FOR PLACER MINING CLAIM

NOTICE IS HEREBY GIVEN

that the **Stockmyer South Ext AMC427437**

placer mining claim has been located by

Ronald Posey

whose current mailing address is

4598 Hawaina Way

Kelseyville, Ca 95451

The general course of this claim is North to South and it is situated in Yavapai County, Arizona.

This Claim is irregular in shape

Beginning at the SE corner monument **on which this location notice is posted** course due West 1320 ft to the SW corner, then course 510 ft. due North to the next corner then course 865 ft at 21 degrees NE to the NW corner then, course 1020 ft due East to the NE corner, then course 1320 ft due South back to the beginning at the SE corner of this claim.

This claim is marked by 5 monuments, one at each corner of the claim

The location monument on which this notice is posted is situated within Section 25, Township 9N, Range 5W Gila and Salt River Meridian, Weaver Mining District, Yavapai County, Arizona.

This claim encompasses portions of the following quarter section(s), **NW of section 25, T9N, R5W, Gila and Salt River Meridian, Weaver Mining District, Yavapai County, Arizona.**

The locality of this claim with reference to some natural object or permanent monument and additional information (if any) concerning its locality is as follows:

1. The **SE** corner of the claim is 2640 feet due South then 2640 ft due West of the NE corner survey monument of Section 25, T9N, R5W Gila and Salt River Meridian, Weaver Mining District, Yavapai County, Arizona.

DATED AND POSTED on the ground this 26th day of, February 2014.

LOCATOR(s) Ronald Posey Ronald Posey
Mary Posey Mary Posey
Agent Only () _____

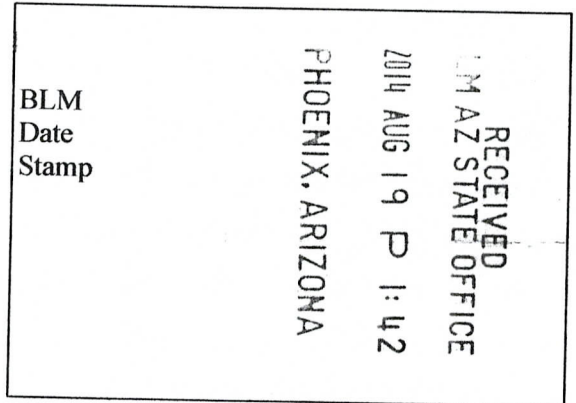

AMC427437

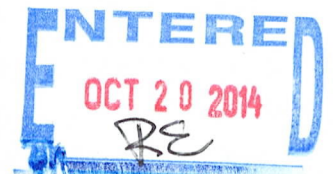

Location Notice for Placer Mining Claim

AMENDMENT AMC 427437

MINING CLAIM MAP

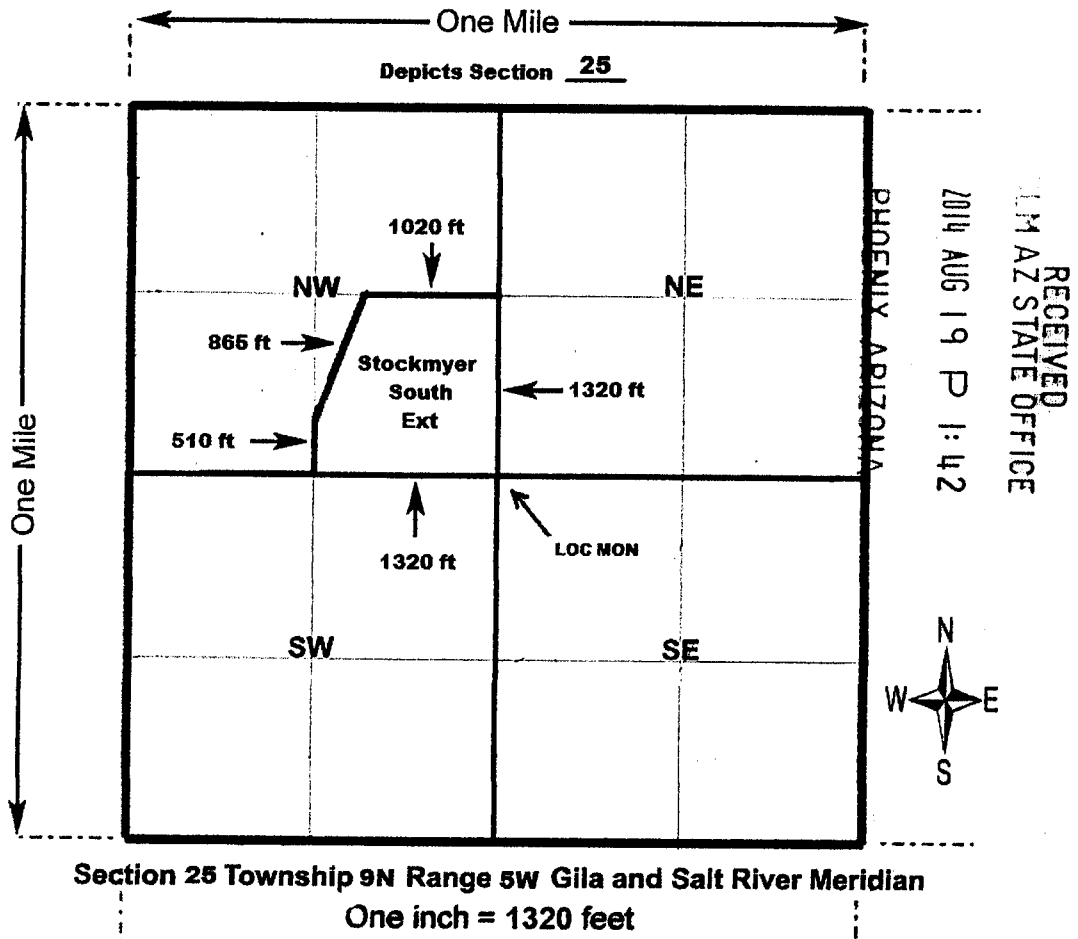

**Section 25 Township 9N Range 5W Gila and Salt River Meridian
One inch = 1320 feet**

1. The above map depicts the STOCKMYER SOUTH EXT placer mining claim located in Section 25 Township 9N Range 5W Gila and Salt River Meridian, WEAVER MINING District, YAVAPAI County, Arizona.
2. The Type of corner and location monuments used are 2 inch white PVC posts more than 4 foot tall.
3. The bearings and distances in degrees and feet feet between claim corners are as depicted on the above map.

Mail To

LOCATION NOTICE FOR PLACER MINING CLAIM

NOTICE IS HEREBY GIVEN

that the Stockmyer South Ext

placer mining claim has been located by

Ronald Posey

whose current mailing address is

4598 HAWAIIA Way
Kelseyville, CA
95451

The general course of this claim is North to South and it is situated in Yavapai County, Arizona.

BLM
Date
Stamp

RECEIVED
BLM AZ STATE OFFICE
2014 FEB 28 A 11: 57
PHOENIX, ARIZONA

This Claim is irregular in shape

Beginning at the SE corner monument on which this location notice is posted course due West 1510 ft to the SW corner, then course 1400 ft. at 21 degrees NE to the NW corner then, course 1020 ft due East to the NE corner, then course 1320 ft due South back to the beginning at the SE corner of this claim.

This claim is marked by 4 monuments, one at each corner of the claim

The location monument on which this notice is posted is situated within Section 25, Township 9N, Range 5W Gila and Salt River Meridian, Weaver Mining District, Yavapai County, Arizona.

This claim encompasses portions of the following quarter section(s), NW of section 25, T9N, R5W, Gila and Salt River Meridian, Weaver Mining District, Yavapai County, Arizona.

The locality of this claim with reference to some natural object or permanent monument and additional information (if any) concerning its locality is as follows:

1. The SE corner of the claim is 2640 feet due South then 2640 ft due West of the NE corner survey monument of Section 25, T9N, R5W Gila and Salt River Meridian, Weaver Mining District, Yavapai County, Arizona.

DATED AND POSTED on the ground this 26th day of, February 2014.

LOCATOR(s) RONALD POSEY Ronald Posey
Mary POSEY Mary Posey
Agent Only ()

AMC 4214371

Location Notice for Placer Mining Claim

MINING CLAIM MAP

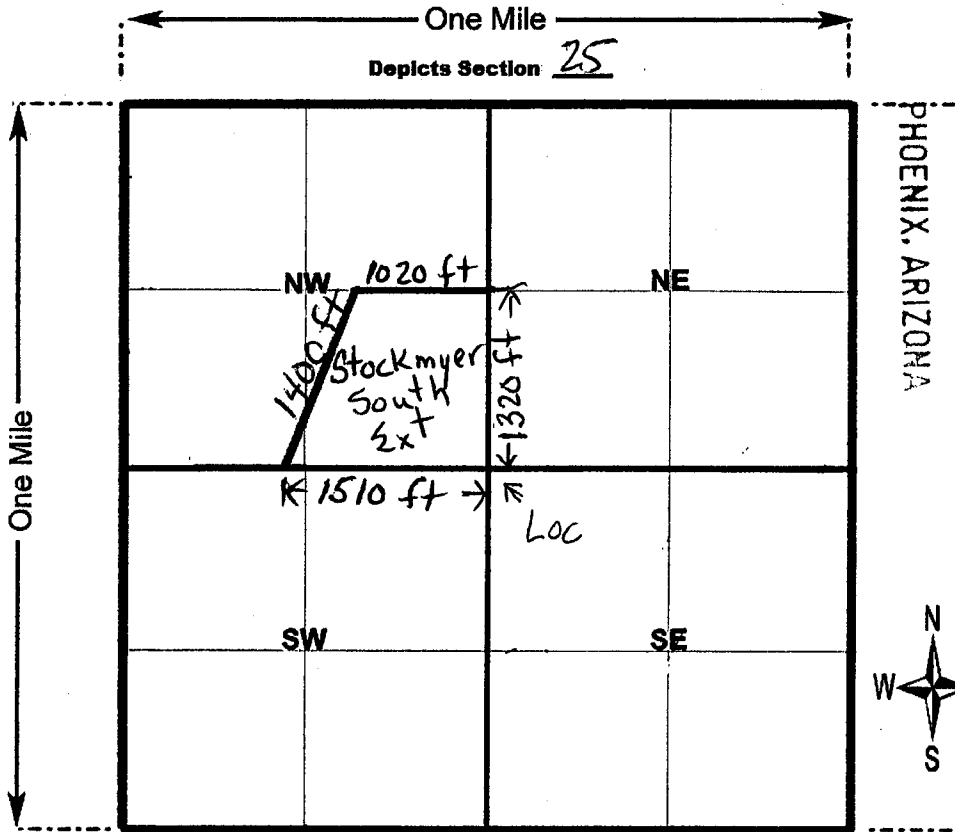

RECEIVED
BLM AZ STATE OFFICE
2014 FEB 28 A 11: 58
PHOENIX, ARIZONA

Section 25 Township 9N Range 5W Gila and Salt River Meridian
One inch = 1320 feet

1. The above map depicts the Stockmyer South Ext placer mining claim located in Section 25 Township 9N Range 5W Gila and Salt River Meridian, Weaver Mining District, Yavapai County, Arizona.

2. The Type of corner and location monuments used are 2 inch white PVC posts more than 4 foot tall.

3. The bearings and distances in degrees and feet feet between claim corners are as depicted on the above map.

AM04274871

MINING CLAIM STATUS REPORT

Data Entered: 03/17/14 Rasm

MTP Checked By: [Signature]
GEO Checked By: [Signature]

LEAD SERIAL NUMBER: AMC 427434 thru AMC 427437

NUMBER OF CLAIMS & TYPE:

- LODE
- PLACER
- 4 ASSOCIATION PLACER
- MILL SITE
- TUNNEL SITE

CHARGES:

Location Fee @ \$34 =	\$	<u>136</u>
Processing Fee @ \$20 =	\$	<u>80</u>
Maintenance Fee @ \$140 =	\$	<u>560</u>
Add'l Maint Fee for Assoc Placer =	\$	<u>560</u>
SUBTOTAL	\$	
Other Fees	\$	
Other Fees	\$	
TOTAL	\$	<u>1,336</u>

TOTAL ACREAGE: 40, 33-61, Per Claim
(Placer Only) 40, 39

NUMBER OF LOCATORS: 2 ea

DOCUMENTS RECEIVED VIA : Over-the-Counter Mail TIMELY FILED: Yes No

LEGAL DESCRIPTION: T 9N R 5W SEC 25

T _____ R _____ SEC _____

T _____ R _____ SEC _____

T _____ R _____ SEC _____

T _____ R _____ SEC _____

BLM FOREST SERVICE SUBJ TO PL 359: Yes No
WILDERNESS AREA

SPLIT ESTATE: N/A SX PX OTHER
SRHA Was proper Notice filed if located on SHRA Land? Yes No

RECONVEYED MINERALS ON BLM LAND REQUIRE OPENING ORDER FROM 1944 TO 1993:

Open to Entry On _____ N/A

COMMENTS/STATUS: VOID PARTIALLY VOID PVT MINERALS WITHDRAWN LANDS
OTHER

Notice to be sent to correct irregular shape? AMC 427437

PHX - 071832 Inquiry re: AMC 427435

QCD Recon

ALL MIN

Claimant acknowledges that portions of the following claim(s) site(s) may be void or voidable.

Printed Name of Claimant _____ Signature of Claimant _____

*****FINAL ADJUDICATION*****

DATE 2.17.14 INITIALS [Signature]

AMC 427434

Mail To

LOCATION NOTICE FOR PLACER MINING CLAIM

NOTICE IS HEREBY GIVEN

that the Stockmyer North

placer mining claim has been located by

RONALD POSEY

whose current mailing address is

4598 HAWAIIA WAY
Kelseyville, CA
95451

The general course of this claim is North to South and it is situated in Yavapai County, Arizona.

BLM Date Stamp	RECEIVED BLM AZ STATE OFFICE 2014 FEB 28 A 11: 51 PHOENIX, ARIZONA
----------------------	---

This Claim is 1320 feet in length and 1320 feet in width

Beginning at the SE corner monument on which this location notice is posted course due West 1320 ft to the SW corner, then course 1320 ft due North to the NW corner then, course 1320 ft due East to the NE corner, then course 1320 ft due South back to the beginning at the SE corner of this claim.

This claim is marked by 4 monuments, one at each corner of the claim

The location monument on which this notice is posted is situated within Section 25, Township 9N, Range 5W Gila and Salt River Meridian, Weaver Mining District, Yavapai County, Arizona.

This claim encompasses portions of the following quarter section(s), NE of section 25, T9N, R5W, Gila and Salt River Meridian, Weaver Mining District, Yavapai County, Arizona.

The locality of this claim with reference to some natural object or permanent monument and additional information (if any) concerning its locality is as follows:

1. The NE corner of the claim is 1320 feet due West of the NE corner survey monument of Section 25, T9N, R5W Gila and Salt River Meridian, Weaver Mining District, Yavapai County, Arizona.

DATED AND POSTED on the ground this 26th day of February 2014.

LOCATOR(s) RONALD POSEY Ronald Posey
MARY POSEY Mary Posey

Agent Only () _____

AMC 421434

Location Notice for Placer Mining Claim

MINING CLAIM MAP

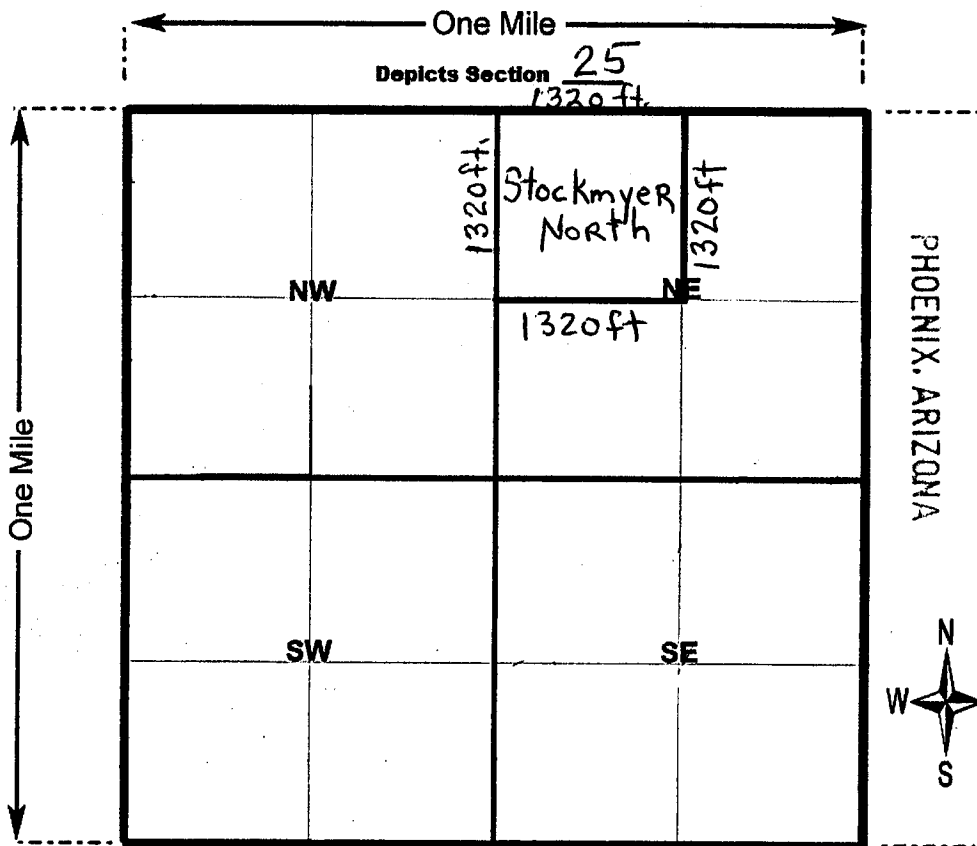

RECEIVED
 DLM AZ STATE OFFICE
 2014 FEB 28 A 11: 51
 PHOENIX, ARIZONA

AMC427434

Section 25 Township 9N Range 5W Gila and Salt River Meridian
 One inch = 1320 feet

1. The above map depicts the Stockmyer North placer mining claim located in Section 25 Township 9N Range 5W Gila and Salt River Meridian, Weaver Mining District, Yavapai County, Arizona.
2. The Type of corner and location monuments used are 2 inch white PVC posts more than 4 foot tall.
3. The bearings and distances in degrees and feet between claim corners are as depicted on the above map.

MAIL TO

LOCATION NOTICE FOR PLACER MINING CLAIM

NOTICE IS HEREBY GIVEN

that the Stockmyer South

placer mining claim has been located by

RONALD POSEY

whose current mailing address is

4598 HAWAIIA WAY
Kelseyville, CA 95451

The general course of this claim is North to South and it is situated in Yavapai County, Arizona.

This Claim is 1320 feet in length and 1320 feet in width

Beginning at the NE corner monument on which this location notice is posted course due South 1320 ft to the SE corner, then course 1320 ft due West to the SW corner then, course 1320 ft due North to the NW corner, then course 1320 ft due East back to the beginning at the NE corner of this claim.

This claim is marked by 4 monuments, one at each corner of the claim

The location monument on which this notice is posted is situated within Section 25, Township 9N, Range 5W Gila and Salt River Meridian, Weaver Mining District, Yavapai County, Arizona.

This claim encompasses portions of the following quarter section(s), NE of section 25, T9N, R5W, Gila and Salt River Meridian, Weaver Mining District, Yavapai County, Arizona.

The locality of this claim with reference to some natural object or permanent monument and additional information (if any) concerning its locality is as follows:

1. The NE corner of the claim is 1320 feet due South and 1320 feet due West of the NE corner survey monument of Section 25, T9N, R5W Gila and Salt River Meridian, Weaver Mining District, Yavapai County, Arizona.

DATED AND POSTED on the ground this 26th day of, February, 2014

LOCATOR(s)

RONALD POSEY Ronald Posey
MARY POSEY Mary Posey

Agent Only ()

BLM
Date
Stamp

RECEIVED
BLM AZ STATE OFFICE
2014 FEB 28 A 11:57
PHOENIX, ARIZONA

AMC427436

Location Notice for Placer Mining Claim

MINING CLAIM MAP

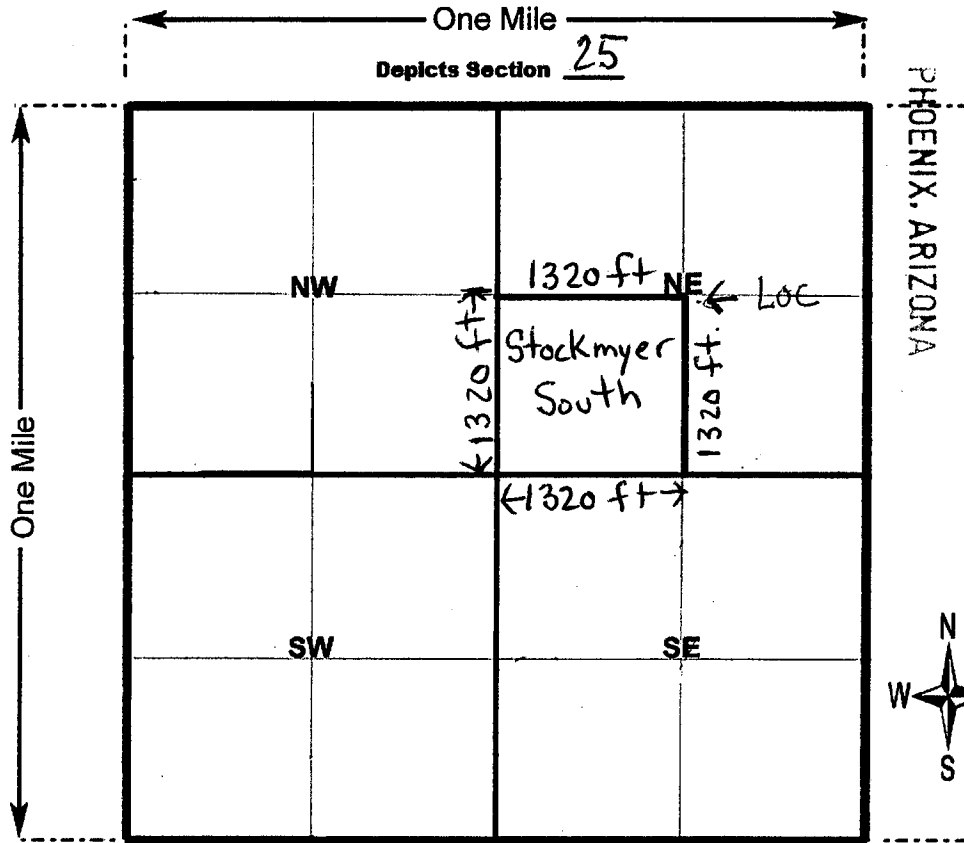

RECEIVED
 CLM AZ STATE OFFICE
 PHOENIX, ARIZONA
 2014 FEB 28 A 11: 57

AMC 4 2 14 36

Section 25 Township 9N Range 5W Gila and Salt River Meridian
 One inch = 1320 feet

1. The above map depicts the Stockmyer South placer mining claim located in Section 25 Township 9N Range 5W Gila and Salt River Meridian, Weaver Mining District, Yavapai County, Arizona.
2. The Type of corner and location monuments used are 2 inch white PVC posts more than 4 foot tall.
3. The bearings and distances in degrees and feet feet between claim corners are as depicted on the above map.

DEPARTMENT OF INTERIOR
BUREAU OF LAND MANAGEMENT

Input Parameters for Geographic Report with Land

System Id = CR

Admin State = AZ

Geo State =

Casetype Begins With

Case Disp Txt = AUTHORIZED, CANCELLED, EXPIRED, PENDING, REJECTED, RELINQUISHED, VOID, WITHDRAWN

Mer Twp Rng =

Section =

Mtrs = 14 0090N 0050W 025, 14 0090N 0050W 999

Commodity =

Commodity Txt =

Pending Org =

Pend Org Decode =

Total Rows Returned: 2

RUN TIME: 11:54 AM

UNITED STATES DEPARTMENT OF INTERIOR
BUREAU OF LAND MANAGEMENT
GEOGRAPHIC REPORT WITH LAND
Sorted by Serial Number

RUN DATE: 02/28/2014

Page 1 of 1

Adm State: AZ

Serial Number: AZAR 0000110

Total Case Acres: 16.660

<u>Casetype</u>	<u>Case Disp</u>				<u>Sect</u>	<u>Sur Typ</u>	<u>Sur Num</u>	<u>Suff</u>	<u>Subdivision</u>	<u>Act Pend</u>
285003	AUTHORIZED	14	0090N	0050W	025	ALIQ			NWNW;	

Serial Number: AZAR 0034626

Total Case Acres: 26.550

<u>Casetype</u>	<u>Case Disp</u>				<u>Sect</u>	<u>Sur Typ</u>	<u>Sur Num</u>	<u>Suff</u>	<u>Subdivision</u>	<u>Act Pend</u>
286202	AUTHORIZED	14	0090N	0050W	025	ALIQ			E2W2;	

